

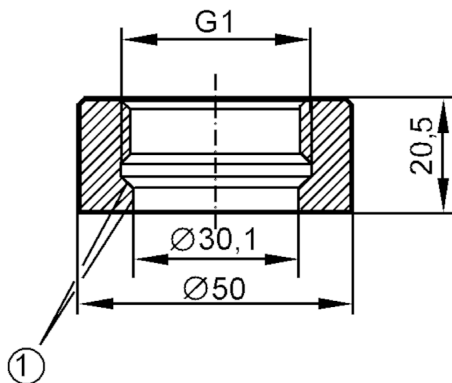

Welding adapter for process sensors

PA WELDING ADAPTER G1 V4A

Article no longer available - archive entry



1 sealing edge

Tests / approvals	
Pressure Equipment Directive	A possible classification to PED depends on the application and has to be carried out by the user / operator.
Safety instructions	The compatibility between medium and product material has to be checked in all applications.
Mechanical data	
Materials	stainless steel (1.4404 / 316L)
Remarks	
Pack quantity	1 pcs.