

# E30516

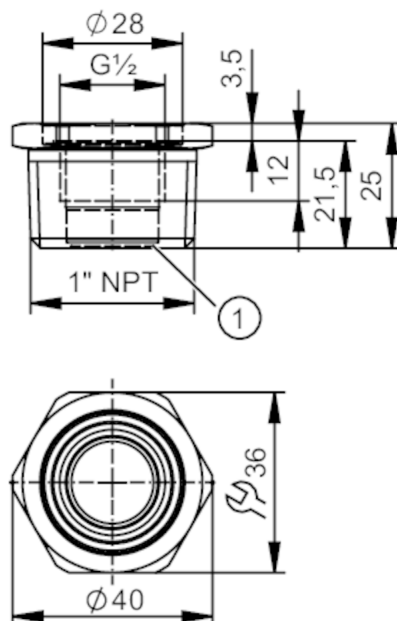

## Screw-in adapter for process sensors

ADAPT G1/2 / 1NPT



1 sealing edge

### Application

Pressure rating [bar] 400

### Tests / approvals

Pressure Equipment Directive

A possible classification to PED depends on the application and has to be carried out by the user / operator.

Safety instructions

The compatibility between medium and product material has to be checked in all applications.

### Mechanical data

Weight [g] 131.6

Materials stainless steel (1.4435 / 316L)

Sensor connection G 1/2

Process connection threaded connection 1" NPT

### Remarks

Pack quantity 1 pcs.