

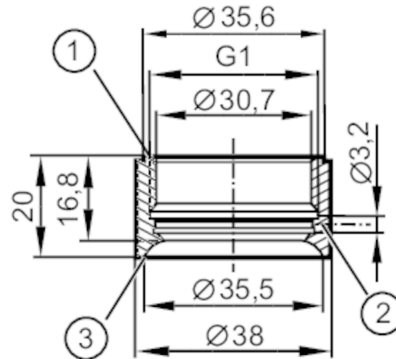

Welding adapter for process sensors

WELDING ASEPTO ADAPT D38/G1



- 1 Aseptoflex Vario
- 2 Leakage port
- 3 sealing area

Application

Design	with leakage port, для встановлення LDL20x
Pressure rating [bar]	50
Note on pressure rating	for the connection sensor - adapter

Tests / approvals

Pressure Equipment Directive	A possible classification to PED depends on the application and has to be carried out by the user / operator.
Safety instructions	The compatibility between medium and product material has to be checked in all applications.

Mechanical data

Weight [g]	113.8
Materials (wetted parts)	stainless steel (316L/1.4435) ; surface characteristics : Ra<0,4 / Rz 4
Sensor connection	G 1 Aseptoflex Vario
Process connection	welding adapter Ø 38 mm

Remarks

Pack quantity	1 pcs.
---------------	--------