

E12164

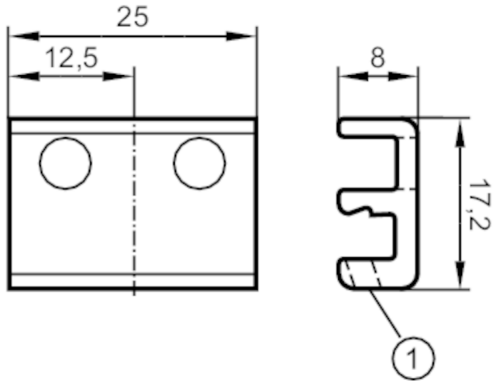

Mounting adapter for Bosch Rexroth pneumatic cylinders

ADAPT FOR ICL AND CDN CYL



1 Mounting screw SW 1.5

Application	
Design	for types MKT
Mechanical data	
Weight [g]	6.2
Type of mounting	fixing: socket head screw M3; for series: Festo DCD, Festo CDN, Bosch ICL
Materials	Adapter: aluminium anodised; screw: stainless steel
Tightening torque [Nm]	0.4
Аксессуары	
Items supplied	Mounting screw
Remarks	
Pack quantity	1 pcs.