

Mounting sleeve with end stop

FIXING/M30/BASIC/MS/END STOP

phase-out article

Discontinuation date: 09/30/2024

Alternative articles: E12747

When selecting an alternative article and accessories please note that technical data may differ!

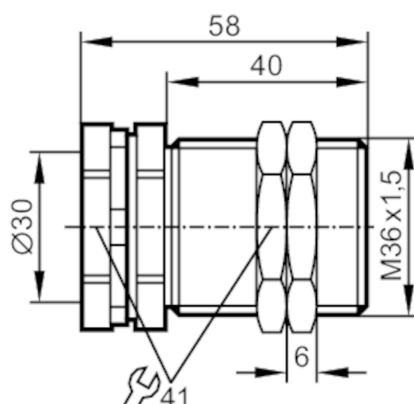

Application

Design

with end stop

Mechanical data

Weight

[g]

192.7

Installation instruction

align the sensing face of the sensor to the right (see scale drawing)

Dimensions

[mm]

M36 x 1.5 / L = 58

Thread designation

M36 x 1.5

Inside diameter

[mm]

30

Materials

brass white bronze coated; Nuts: brass white bronze coated

Tightening torque

[Nm]

20; (lock nuts: 40)

Аксессуары

Items supplied

Nuts: 2

Remarks

Pack quantity

1 pcs.