

# AC5001



## Lower part for AS-Interface module

ASI-MODUL-UNTERTEIL PG

Article no longer available - archive entry

Alternative articles: AC5101

When selecting an alternative article and accessories please note that technical data may differ!

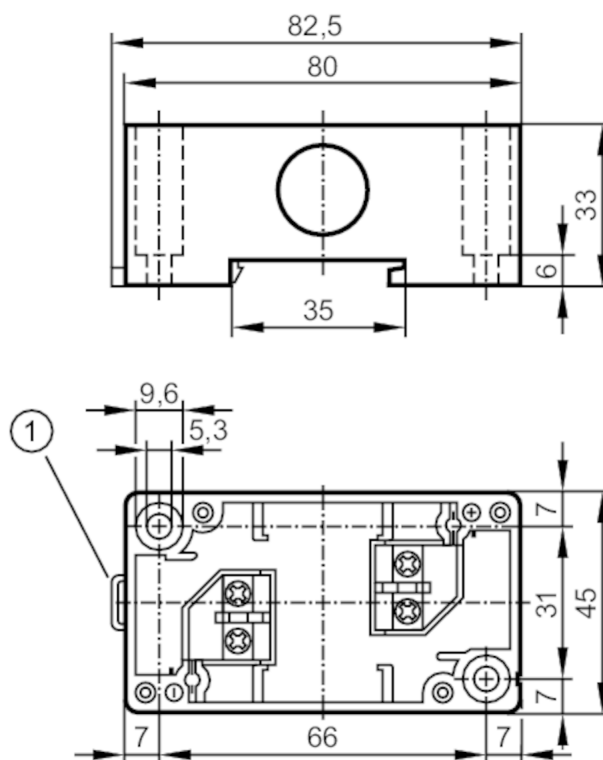

1 locking bolt

### Electrical data

Operating voltage [V] 26.5...31.6 DC

### Outputs

Electrical design AS-i  
Contact rating < 4 A

### Operating conditions

Ambient temperature [°C] -25...85  
Protection IP 65

### Mechanical data

Type of mounting mounting on DIN rail and panel  
Dimensions [mm] 45 x 82.5 x 33  
Materials PBT

### Remarks

Remarks up to 4 screw connection cable ports for any type of T or cross branch  
Pack quantity 1 pcs.

### Electrical connection

screw terminals: ...2.5 mm<sup>2</sup>