



AS-Interface PROFIBUS DP gateway with PLC

Contr 1MSTR 1RS232C 1DP

Article no longer available - archive entry

Alternative articles: AC1027
When selecting an alternative article and accessories please note that technical data may differ!

Replacement units for Krones systems should be obtained directly from the company Krones.
This unit is not directly compatible.

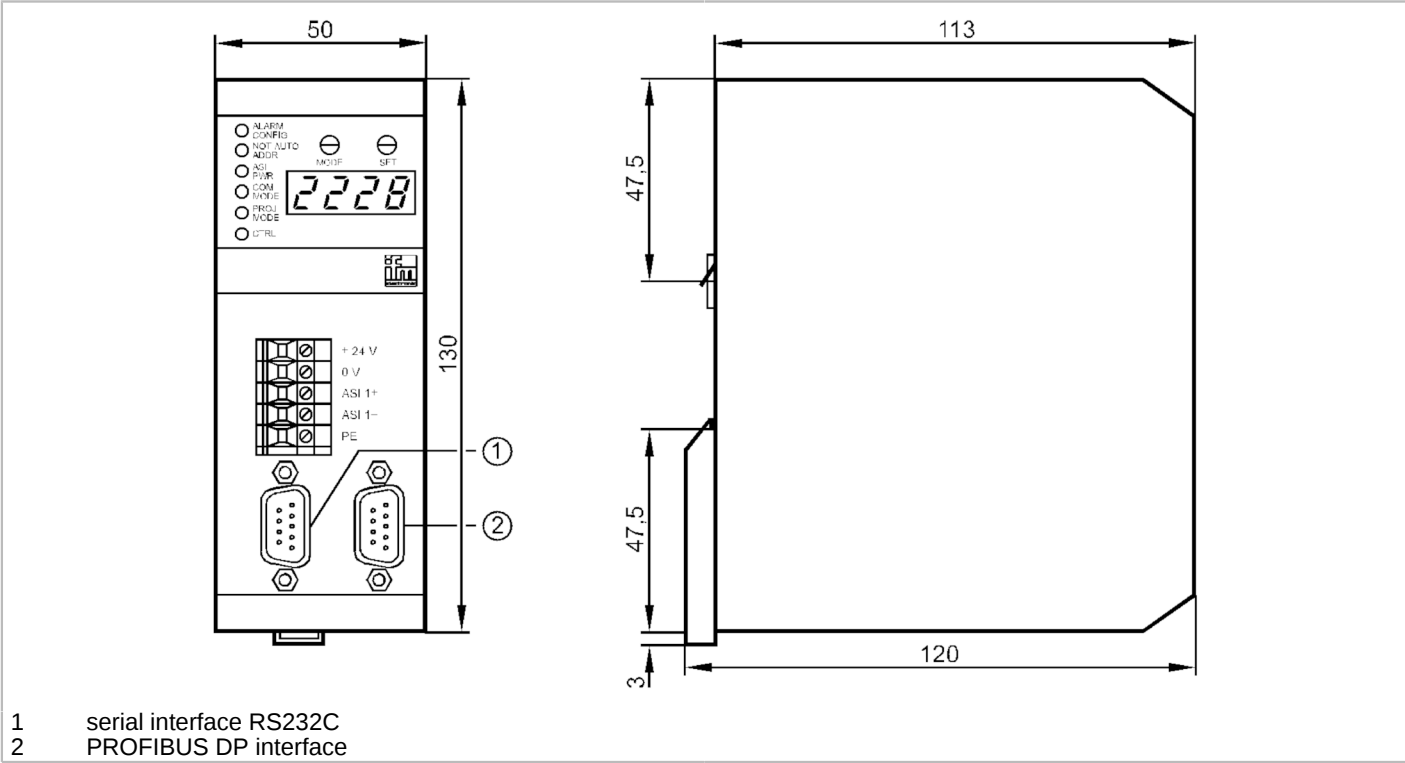

Application	
Application	use as minicontroller and gateway
Electrical data	
Operating voltage [V]	22...30 DC; (24 DC ; to PELV)
Insulation rating [V]	500
Max. current consumption [mA]	80
Max. power consumption [VA]	10
Electrical separation	yes
Outputs	
Electrical design	AS-i
Interfaces	
Communication interface	RS232
RS232	
Number of R232 interfaces	1
Transmission rate	4800...62400 Baud



AS-Interface PROFIBUS DP gateway with PLC

Contr 1MSTR 1RS232C 1DP

Connector type	SUB-D
Usage type	programming

Operating conditions	
Ambient temperature [°C]	0...60
Storage temperature [°C]	-20...70
Max. relative air humidity [%]	95
Protection	IP 20

AS-i classification	
AS-i profile	M1
AS-i certificate	22501

Mechanical data	
Housing	housing for DIN rail mounting
Materials	aluminium

Displays / operating elements		
Display	function check	2 x LED, red
		2 x LED, green
		2 x LED, yellow

Remarks	
Remarks	Replacement units for Krones systems should be obtained directly from the company Krones.
	This unit is not directly compatible.
Notes	Replacement units for Krones systems should be obtained directly from the company Krones.; This unit is not directly compatible.
Pack quantity	1 pcs.

Electrical connection	
screw terminals: 5 x	
Connection	

5	+ 24 V
4	0 V
3	AS-i 1+
2	AS-i 1–
1	PE