

RB1015



Incremental encoder with solid shaft

RB-0500-I05/L2

Article no longer available - archive entry

Alternative article: RB3500 When selecting an alternative article and accessories please note that technical data may differ! –
When selecting an alternative article and accessories please note that technical data may differ! – Discontinuation date: 31.03.2016

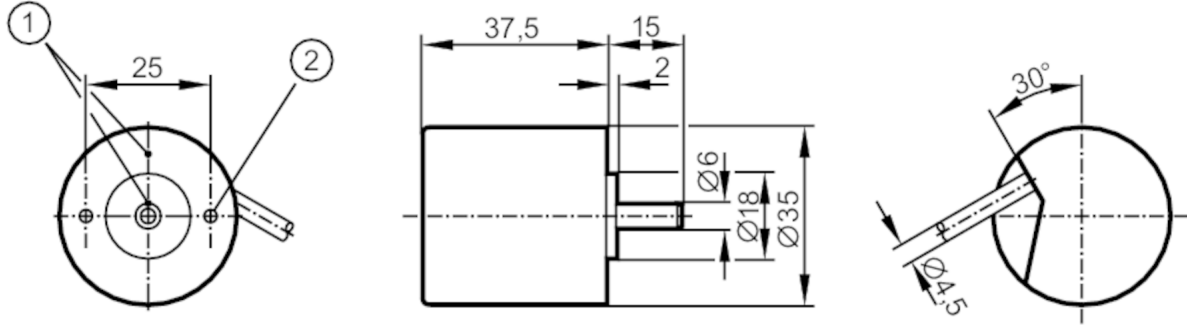

- 1 reference mark
- 2 M3 Depth 5 mm



Product characteristics	
Resolution	500 resolution
Shaft design	solid shaft
Shaft diameter [mm]	6
Application	
Function principle	incremental
Electrical data	
Operating voltage tolerance [%]	10
Operating voltage [V]	5 DC
Current consumption [mA]	120
Outputs	
Electrical design	TTL
Max. current load per output [mA]	20
Switching frequency [kHz]	300
Phase difference A and B [°]	90
Measuring/setting range	
Resolution	500 resolution
Operating conditions	
Ambient temperature [°C]	-40...100
Note on ambient temperature	for firmly laid cable
Max. relative air humidity [%]	75; (briefly: 95 %)
Protection	IP 64

RB1015



Incremental encoder with solid shaft

RB-0500-I05/L2

Tests / approvals		
Shock resistance		100 g (6 ms)
Vibration resistance		10 g (55...2000 Hz)
MTTF	[years]	190
Mechanical data		
Weight	[g]	268.4
Dimensions	[mm]	Ø 35 / L = 52.5
Materials		aluminium
Max. revolution, mechanical	[U/min]	10000
Max. starting torque	[Nm]	1
Reference temperature torque	[°C]	20
Shaft design		solid shaft
Shaft diameter	[mm]	6
Shaft material		steel (1.4104)
Max. shaft load axial (at the shaft end)	[N]	5
Max. shaft load radial (at the shaft end)	[N]	10
Remarks		
Notes		discontinued article
Electrical connection		
Cable: 2 m, PUR; radial, can also be used axially		
brown	A	
green	A inverted	
grey	B	
pink	B inverted	
red	0 index	
black	0 index inverted	
brown/green	L+ (Up)	
white/green	L- 0 V (Un)	
blue	L+ sensor	
white	L- 0 V sensor	
lilac	failure inverted	
screen	housing	
Diagrams and graphs		
Pulse diagram		<p>Output A Output B 0 index</p>

RB1015

Incremental encoder with solid shaft

RB-0500-I05/L2



Article no longer available - archive entry

Alternative article: RB3500 When selecting an alternative article and accessories please note that technical data may differ! –
When selecting an alternative article and accessories please note that technical data may differ! – Discontinuation date: 31.03.2016