

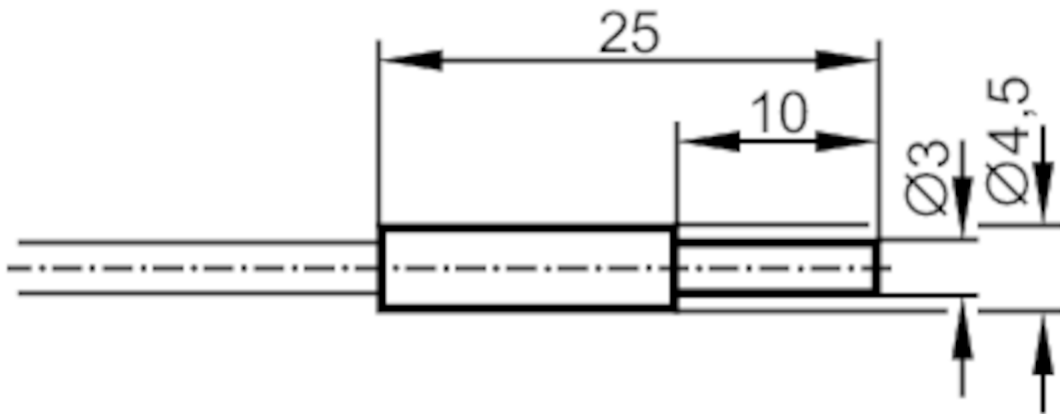

## Fibre optic through beam sensor

FE-30-P-A-E3

Article no longer available - archive entry



### Application

Function principle Through-beam sensor

### Detection zone

Range with fibre optic amplifier type OIF

### OIF

Range of fibre optics [mm] 100

### Operating conditions

Ambient temperature [°C] -20...80

### Mechanical data

Version of sensing head straight

Sensing head diameter [mm] 3

Total length [mm] 600

Min. bending radius [mm] 30

Fibre arrangement ●

Materials Adapter: PA

Fibre material glass

Fibre head material aluminium

Fibre sheath material PVC

# E20166



## Fibre optic through beam sensor

FE-30-P-A-E3

Accessories	
Accessories (supplied)	E20105
Remarks	
Pack quantity	1 pcs.

Article no longer available - archive entry