

# ST2200



## Flow sensor for connection to an evaluation unit

STR14ABB

Article no longer available - archive entry

Alternative articles: ST2204

When selecting an alternative article and accessories please note that technical data may differ!

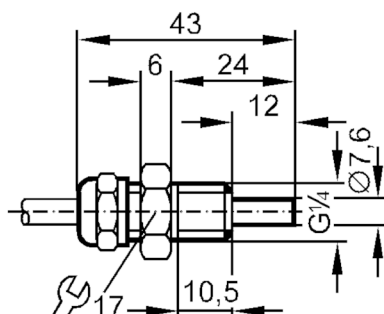

### Product characteristics

Process connection	G 1/4 external thread
--------------------	-----------------------

### Application

Application	high-temperature range
Media	Liquids; Gases
Medium temperature [°C]	-25...80
Pressure rating [bar]	30

### Liquids

Application	high-temperature range
Medium temperature [°C]	-25...80

### Gases

Medium temperature [°C]	-25...80
-------------------------	----------

### Electrical data

Connection to control monitor	VS 0100
-------------------------------	---------

### Measuring/setting range

#### Liquids

Setting range [cm/s]	3...300
Greatest sensitivity [cm/s]	3...60

#### Gases

Setting range [cm/s]	5...1500
----------------------	----------

### Accuracy / deviations

Temperature gradient [K/min]	15
------------------------------	----

### Response times

Response time [s]	1...10
-------------------	--------

#### Liquids

Response time [s]	1...10
-------------------	--------

#### Gases

Response time [s]	1...10
-------------------	--------

# ST2200



## Flow sensor for connection to an evaluation unit

STR14ABB

Operating conditions	
Protection	IP 67
Mechanical data	
Housing	threaded type
Materials	stainless steel (316Ti/1.4571)
Process connection	G 1/4 external thread
Remarks	
Pack quantity	1 pcs.
Electrical connection	
Cable: 2 m, Silflex-PUR; Maximum cable length: 100 m; 4 x 0.5 mm²	
Connection	

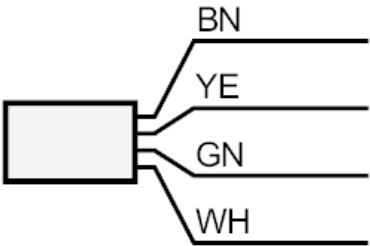

	Core colours :
BK =	black
BN =	brown
BU =	blue
WH =	white