

Mounting adapter for flow sensors

SREW-IN ADAPTER 1" SM

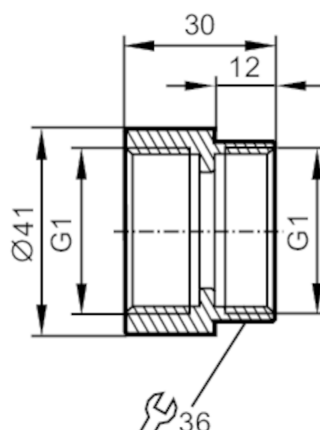

Application

Design

for flow sensors Typ SM8, SU8

Tests / approvals

Pressure Equipment Directive

A possible classification to PED depends on the application and has to be carried out by the user / operator.

Safety instructions

The compatibility between medium and product material has to be checked in all applications.

Mechanical data

Weight

[g]

300

Materials

Adapter: stainless steel (316L/1.4404); Gasket: Centellen 23,5 x 30 x 3 mm

Sensor connection

G 1

Process connection

threaded connection G 1

Accessories

Items supplied

O-rings: 2

Remarks

Pack quantity

2 pcs.