

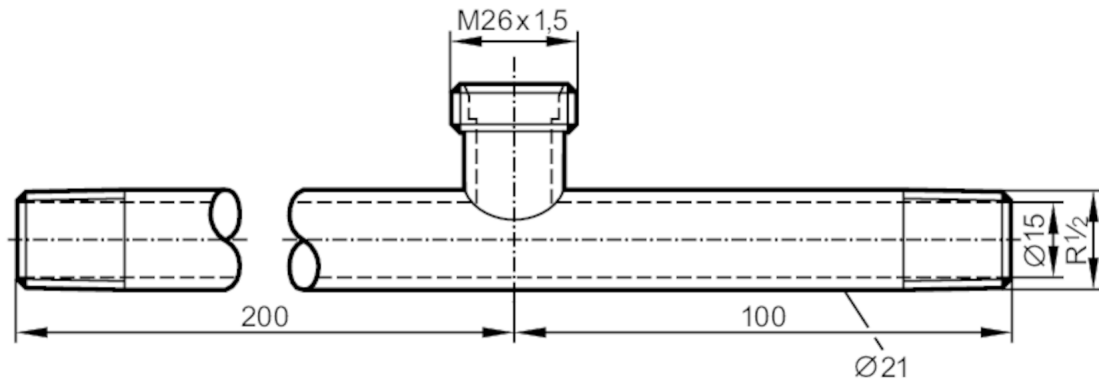

T-piece

T-PIECE R1/2-M26X1.5-R1/2



Application

| | | |
|-----------------|---------|--|
| Design | | for sensors and adapters with process connection M26x1,5 |
| Flow range | [l/min] | 0...10 |
| Application | | for industrial applications |
| Media | | liquids and gases |
| Pressure rating | [bar] | 30 |

Tests / approvals

| | | |
|------------------------------|--|---|
| Pressure Equipment Directive | | A possible classification to PED depends on the application and has to be carried out by the user / operator. |
| Safety instructions | | The compatibility between medium and product material has to be checked in all applications. |

Mechanical data

| | | |
|--------------------|-----|-------------------------------|
| Weight | [g] | 524.5 |
| Materials | | stainless steel (316L/1.4404) |
| Sensor connection | | M26 x 1,5 |
| Process connection | | threaded connection R 1/2 |

Accessories

| | | |
|------------------------|--|---|
| Accessories (optional) | | Adapter: 1 x M18 x 1,5, for direct connection of flow sensors, E40104 |
|------------------------|--|---|

Remarks

| | | |
|---------------|--|--------|
| Pack quantity | | 1 pcs. |
|---------------|--|--------|