

# IS5027



## Inductive sensor

IS-3002-ANOG/PH

Article no longer available - archive entry

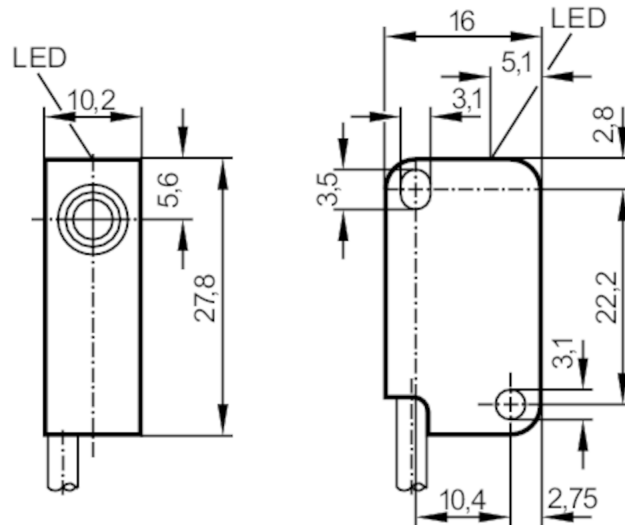

### Product characteristics

|                   |      |               |
|-------------------|------|---------------|
| Electrical design |      | NPN           |
| Output function   |      | normally open |
| Sensing range     | [mm] | 2             |
| Housing           |      | rectangular   |
| Dimensions        | [mm] | 28 x 10 x 16  |

### Electrical data

|                             |      |            |
|-----------------------------|------|------------|
| Operating voltage           | [V]  | 10...36 DC |
| Current consumption         | [mA] | 15; (24 V) |
| Protection class            |      | III        |
| Reverse polarity protection |      | no         |

### Outputs

|   |      |               |
|---|------|---------------|
| Electrical design                               |      | NPN           |
| Output function                                 |      | normally open |
| Max. voltage drop switching output DC           | [V]  | 1             |
| Permanent current rating of switching output DC | [mA] | 200           |
| Switching frequency DC                          | [Hz] | 800           |
| Short-circuit protection                        |      | no            |
| Overload protection                             |      | no            |

### Detection zone

|                          |      |              |
|--------------------------|------|--------------|
| Sensing range            | [mm] | 2            |
| Real sensing range $S_r$ | [mm] | $2 \pm 10\%$ |
| Operating distance       | [mm] | 0...1.6      |

# IS5027



## Inductive sensor

IS-3002-ANOG/PH

| Accuracy / deviations                                      |   |                 |
|--|---|-----------------|
| Correction factor  | steel: 1 / stainless steel: 0.7 / brass: 0.5 / aluminium: 0.4 / copper: 0.3 |                 |
| Hysteresis [% of Sr]                                       | 1...15  |                 |
| Switch point drift [% of Sr]                               | -10...10  |                 |
| Operating conditions                                       |   |                 |
| Ambient temperature [°C]                                   | -25...80  |                 |
| Protection   | IP 67   |                 |
| Tests / approvals  |   |                 |
| EMC  | EN 60947-5-2  |                 |
|  | EN 55011  | class B         |
| MTTF [years]   | 2791  |                 |
| Mechanical data  |   |                 |
| Housing  | rectangular   |                 |
| Mounting   | flush mountable   |                 |
| Dimensions [mm]  | 28 x 10 x 16  |                 |
| Materials  | PBT   |                 |
| Tightening torque [Nm]                                     | < 0.5; (with washer)  |                 |
| Displays / operating elements                              |   |                 |
| Display  | switching status  | 1 x LED, yellow |
| Remarks  |   |                 |
| Pack quantity  | 1 pcs.  |                 |
| Electrical connection                                      |   |                 |
| Cable: 2 m, PUR; highly flexible; 3 x 0.14 mm <sup>2</sup> |   |                 |
| Connection   |   |                 |

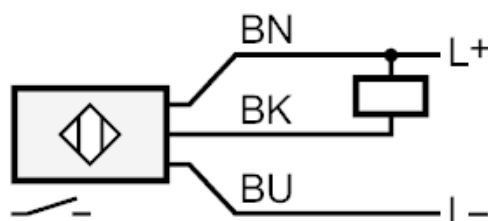

Core colours :

BN = brown  
BU = blue  
BK = black

Article no longer available - archive entry