

## Process adapter Tri-Clamp

ADAPT G3/4-CLAMP ISO2852/1-1.5

Article no longer available - archive entry

Alternative articles: E33201 or E33401

When selecting an alternative article and accessories please note that technical data may differ!

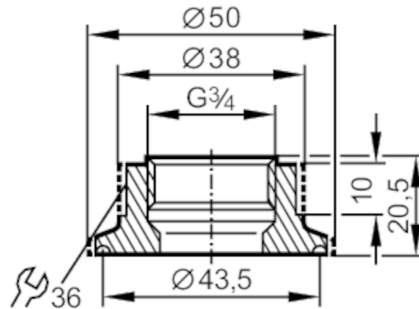

### Application

Pressure rating [bar] 16

### Tests / approvals

Pressure Equipment Directive A possible classification to PED depends on the application and has to be carried out by the user / operator.

Safety instructions The compatibility between medium and product material has to be checked in all applications.

### Mechanical data

Weight [g]	165.5
Materials (wetted parts)	stainless steel (316L/1.4404) ; surface characteristics : Ra<0,4 / Rz 4
Sensor connection	G 3/4
Process connection	Clamp DN25...DN40 (1...1,5") DIN 32676 (ISO 2852)
Hygienic equipment class to DIN 11866	H4

### Remarks

Pack quantity 1 pcs.