

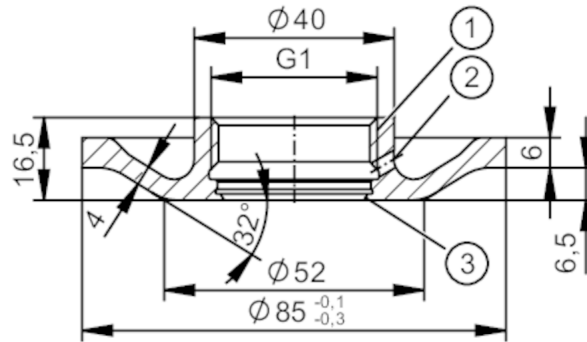

Welding adapter for process sensors

WELDING ADAPT D85 G1 V4A 3A



- 1 G1 internal thread Aseptoflex Vario
- 2 Leakage port
- 3 sealing area



EC 1935/2004 EHEDG Certified



Application

| | |
|-------------------------|--|
| Design | with leakage port |
| Installation | for thick wall thicknesses and for unfavourable welding conditions; for tank bottom and wall |
| Pressure rating [bar] | 16 |
| Note on pressure rating | for the connection sensor - adapter |

Tests / approvals

| | |
|------------------------------|---|
| Pressure Equipment Directive | A possible classification to PED depends on the application and has to be carried out by the user / operator. |
| Safety instructions | The compatibility between medium and product material has to be checked in all applications. |

Mechanical data

| | |
|--------------------------|--|
| Weight [g] | 289.7 |
| Materials (wetted parts) | stainless steel (316L/1.4435) ; surface characteristics : Ra<0,4 / R |
| Sensor connection | G 1 internal thread Aseptoflex Vario |
| Process connection | welding adapter Ø 85 mm |
| Sealing | Gasket |

Accessories

| | |
|------------------------|----------------------------------|
| Items supplied | O-ring: 1 x 24 x 2, EPDM, E30054 |
| Accessories (optional) | O-ring: 1 x 24 x 2, FKM, E30123 |

Remarks

| | |
|---------------|--------|
| Pack quantity | 1 pcs. |
|---------------|--------|