

O6T300

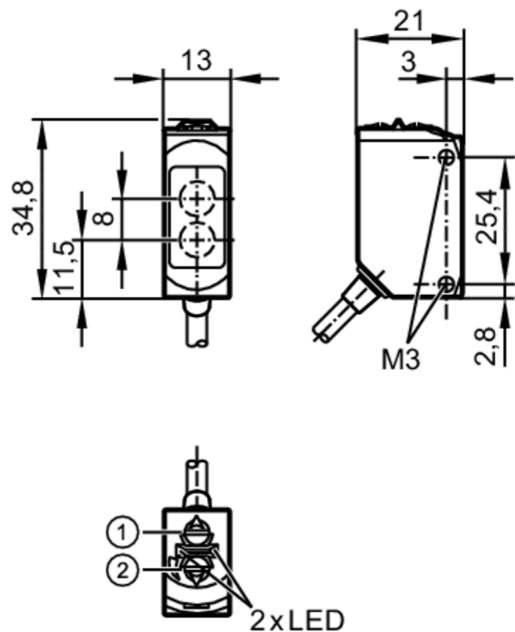

Diffuse reflection sensor

O6T-FPKG



- 1 output function switch
- 1 potentiometer sensitivity
- receiver in upper lens
- transmitter in lower lens



| Product characteristics | | |
|---|------|-------------------------------------|
| Type of light | | red light |
| Housing | | rectangular |
| Application | | |
| Function principle | | Diffuse reflection sensor |
| Electrical data | | |
| Operating voltage | [V] | 10...30 DC |
| Current consumption | [mA] | 16; ((24 V)) |
| Protection class | | III |
| Reverse polarity protection | | yes |
| Type of light | | red light |
| Wave length | [nm] | 633 |
| Outputs | | |
| Electrical design | | PNP |
| Output function | | light-on/dark-on mode; (selectable) |
| Max. voltage drop switching output DC | [V] | 2.5 |
| Permanent current rating of switching output DC | [mA] | 100 |
| Switching frequency DC | [Hz] | 1000 |
| Short-circuit protection | | yes |
| Type of short-circuit protection | | pulsed |

O6T300



Diffuse reflection sensor

O6T-FPKG

| Detection zone | | |
|---|------------------|---|
| Range | [mm] | 5...500; (white paper 200 x 200 mm 90% remission) |
| Setting range | [mm] | 100...500 |
| Range adjustable | | yes |
| Max. light spot diameter | [mm] | 15 |
| Light spot dimensions refer to | | at maximum range |
| Operating conditions | | |
| Ambient temperature | [°C] | -25...80 |
| Protection | | IP 65; IP 67; IP 68; IP 69K |
| Tests / approvals | | |
| EMC | | EN 60947-5-2 |
| MTTF | [years] | 910 |
| UL approval | UL Approval no. | E003 |
| Mechanical data | | |
| Weight | [g] | 81.8 |
| Housing | | rectangular |
| Materials | | housing: stainless steel (316L/1.4404); plastics: PPSU; Sealing: EPDM |
| Lens material | | PMMA |
| Lens alignment | | side lens |
| Tightening torque | [Nm] | 1; (screws) |
| Displays / operating elements | | |
| Display | switching status | 1 x LED, yellow |
| | operation | 1 x LED, green |
| Remarks | | |
| Remarks | | operating voltage "supply class 2" according to cULus |
| Pack quantity | | 1 pcs. |
| Electrical connection | | |
| Cable: 2 m, PVC; 3 x 0.25 mm ² | | |
| Connection | | |

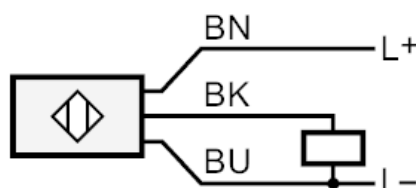

Core colours :
BN = brown
BK = black
BU = blue

Diffuse reflection sensor

O6T-FPKG

Diagrams and graphs

excess gain graph

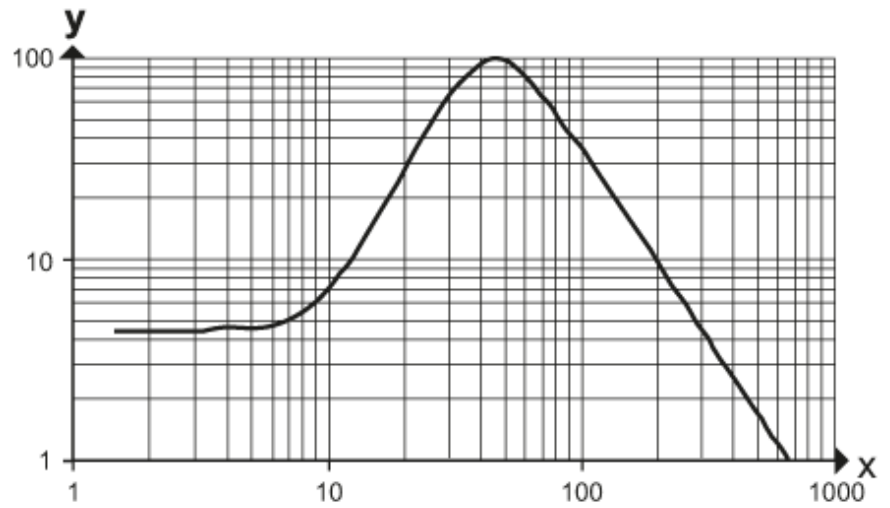

x: distance [mm]

y: excess gain factor