

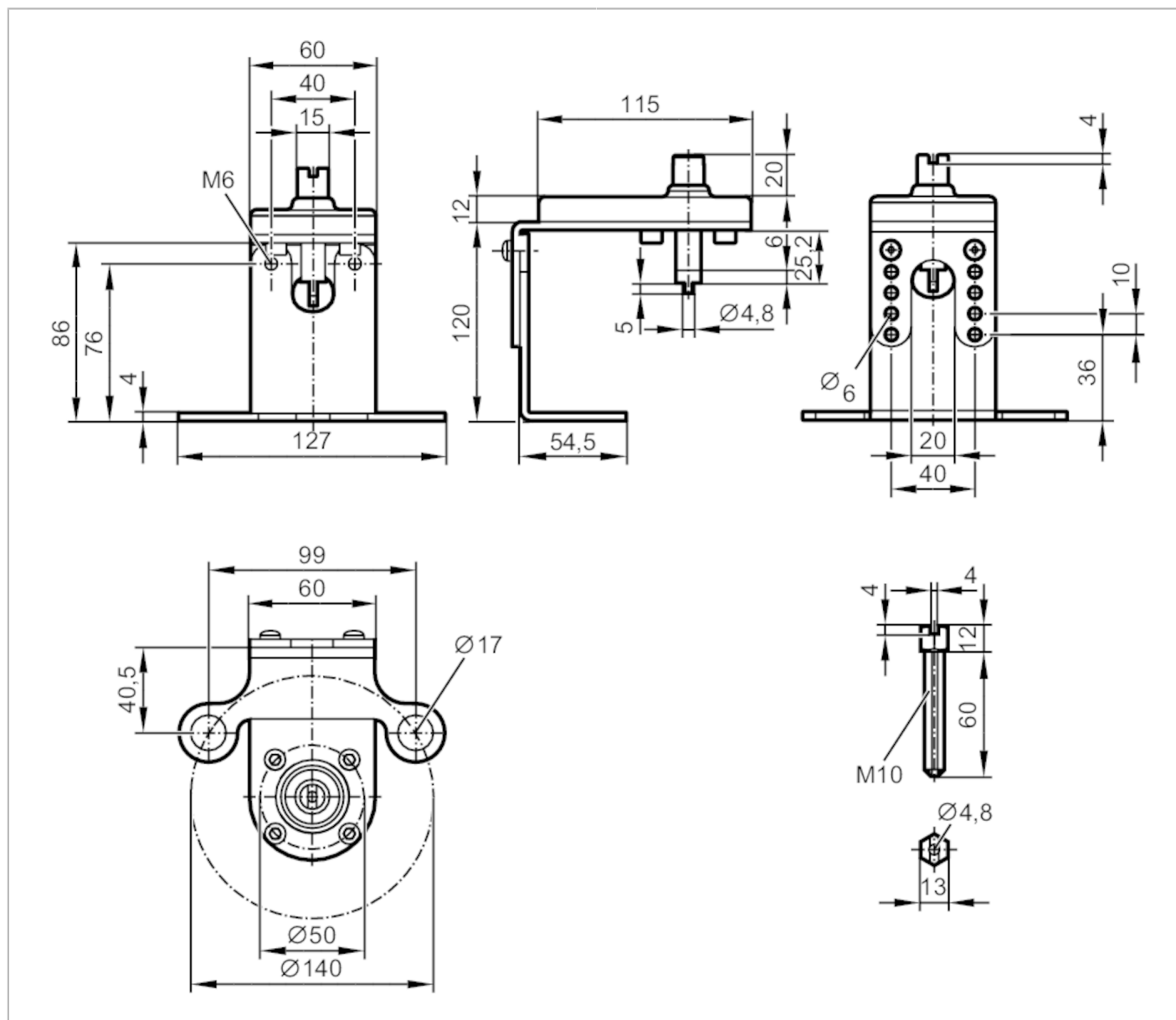

Mounting set for manual valves and ball valves

MOUNTING KIT FOR MANUAL VALVES F14/M10



| Application | | |
|----------------------|---|--------------------|
| Design | | for types IND, INE |
| Operating conditions | | |
| Ambient temperature | [°C] | -30...80 |
| Mechanical data | | |
| Weight | [g] | 719 |
| Top flange diameter | [mm] | 140 |
| ISO top flange type | | F14 |
| Shaft extension | | M10 |
| Materials | Mounting plate: plastics; metal parts: stainless steel (304/1.4301) | |
| Remarks | | |
| Pack quantity | 1 pcs. | |