

E43310

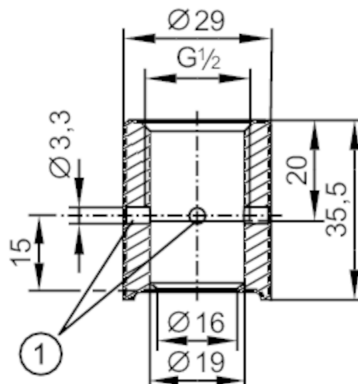

Welding adapter for process sensors

ADAPT G1/2-WELD FOR PIPE 3A



1 Leakage port



| Application | |
|---|-------------------------------------|
| Design | for pipes, with leakage port |
| Pressure rating [bar] | 50 |
| Note on pressure rating | for the connection sensor - adapter |
| Mechanical data | |
| Weight [g] | 160.5 |
| Materials | stainless steel (1.4435 / 316L) |
| Sensor connection | G 1/2 sealing cone |
| Process connection | welding adapter Ø 29 mm |
| Surface characteristics Ra/Rz of the wetted parts | 0.4 / 4 |
| Accessories | |
| Items supplied | O-rings:, FKM |
| Remarks | |
| Pack quantity | 1 pcs. |