

# SF0522



## Flow sensor for connection to an evaluation unit

SFR12ABH

Article no longer available - archive entry

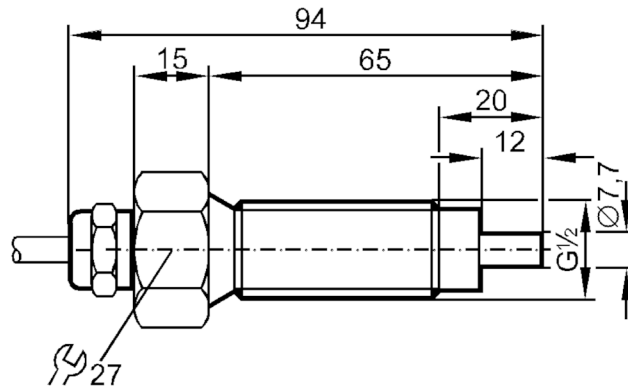

### Application

Media	Liquids; Gases; aggressive media	
Medium temperature	[°C]	-25...80
Pressure rating	[bar]	30

### Liquids

Medium temperature	[°C]	-25...80
--------------------	------	----------

### Gases

Medium temperature	[°C]	-25...80
--------------------	------	----------

### Electrical data

Connection to control monitor	VS 0200
-------------------------------	---------

### Measuring/setting range

#### Liquids

Setting range	[cm/s]	3...300
Greatest sensitivity	[cm/s]	3...60

#### Gases

Setting range	[cm/s]	200...2000
---------------	--------	------------

### Accuracy / deviations

Temperature gradient	[K/min]	15
----------------------	---------	----

### Response times

Response time	[s]	1...10
---------------	-----	--------

#### Liquids

Response time	[s]	1...10
---------------	-----	--------

#### Gases

Response time	[s]	1...10
---------------	-----	--------

# SF0522



## Flow sensor for connection to an evaluation unit

SFR12ABH

Operating conditions	
Protection	IP 67
Mechanical data	
Housing	threaded type
Materials	Hastelloy C-4 (2.4610)
Materials (wetted parts)	Hastelloy C-4 (2.4610)
Process connection	G 1/2 external thread
Accessories	
Accessories (supplied)	sealings: 2 x AMF 30
Remarks	
Pack quantity	1 pcs.
Electrical connection	
Cable: 2 m, PUR; Maximum cable length: 100 m; 5 x 0.34 mm <sup>2</sup>	

### Connection

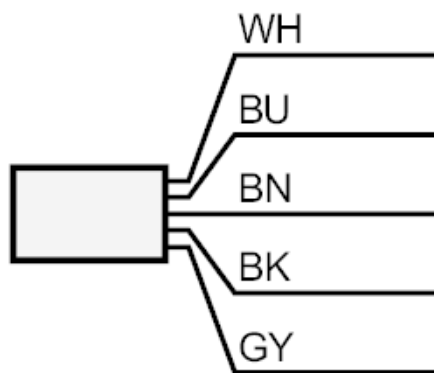

- Core colours :
- BN = brown
  - BU = blue
  - BK = black
  - WH = white
  - GY = grey

Article no longer available - archive entry