

# IS5027



## Inductive sensor

IS-3002-ANOG/PH

Article no longer available - archive entry

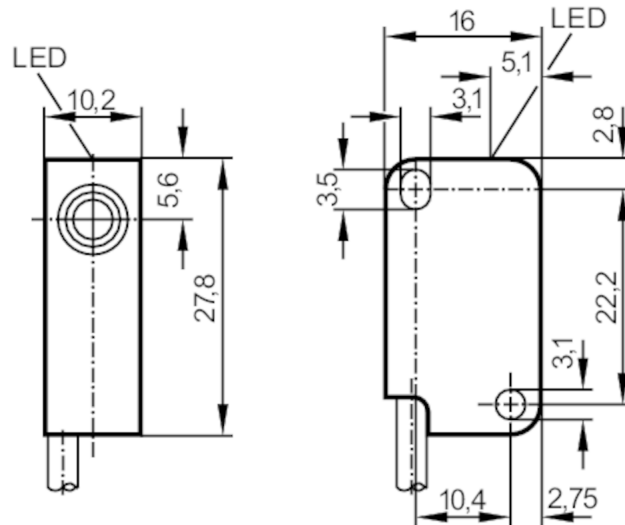

### Electrical data

Operating voltage [V]	10...36 DC
Current consumption [mA]	15; (24 V)
Protection class	III
Reverse polarity protection	no

### Outputs

Electrical design	NPN
Output function	normally open
Max. voltage drop switching output DC [V]	1
Permanent current rating of switching output DC [mA]	200
Switching frequency DC [Hz]	800
Short-circuit protection	no
Overload protection	no

### Detection zone

Sensing range [mm]	2
Real sensing range $S_r$ [mm]	$2 \pm 10\%$
Operating distance [mm]	0...1.6

### Accuracy / deviations

Correction factor	steel: 1 / stainless steel: 0.7 / brass: 0.5 / aluminium: 0.4 / copper: 0.3
Hysteresis [% of $S_r$ ]	1...15
Switch point drift [% of $S_r$ ]	-10...10

# IS5027



## Inductive sensor

IS-3002-ANOG/PH

Operating conditions		
Ambient temperature	[°C]	-25...80
Protection		IP 67
Tests / approvals		
EMC	EN 60947-5-2	
	EN 55011	class B
MTTF	[years]	2791
Mechanical data		
Housing		rectangular
Mounting		flush mountable
Dimensions	[mm]	28 x 10 x 16
Materials		PBT
Tightening torque	[Nm]	< 0.5; (with washer)
Displays / operating elements		
Display	switching status	1 x LED, yellow
Remarks		
Pack quantity		1 pcs.
Electrical connection		
Cable: 2 m, PUR; highly flexible; 3 x 0.14 mm <sup>2</sup>		

### Connection

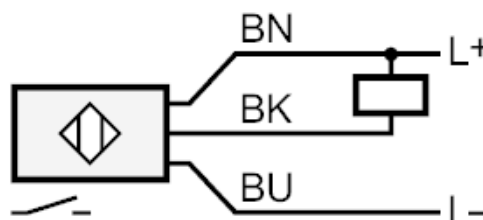

Core colours :

- BN = brown
- BU = blue
- BK = black

Article no longer available - archive entry