

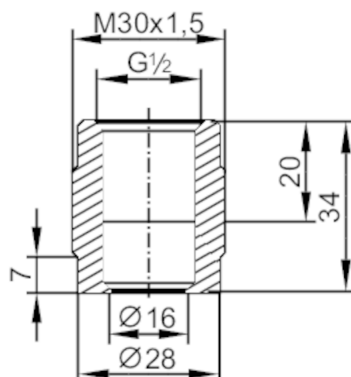

Screw-in adapter for process sensors

ADAPT G1/2-M30X1,5



Tests / approvals

Pressure Equipment Directive

A possible classification to PED depends on the application and has to be carried out by the user / operator.

Safety instructions

The compatibility between medium and product material has to be checked in all applications.

Mechanical data

Weight [g]

141

Dimensions [mm]

M30

Thread designation

M30

Materials

stainless steel (316L/1.4404)

Sensor connection

G 1/2 sealing cone

Process connection

threaded connection M30 x 1,5

Surface characteristics Ra/Rz of the wetted parts

0.4 / 4

Accessories

Items supplied

O-ring

Remarks

Pack quantity

1 pcs.