

Conduit adapter mounting set for connectors

CONDUIT ADAPTER 1/2 NPT

phase-out article

Alternative articles: E30424

When selecting an alternative article and accessories please note that technical data may differ!

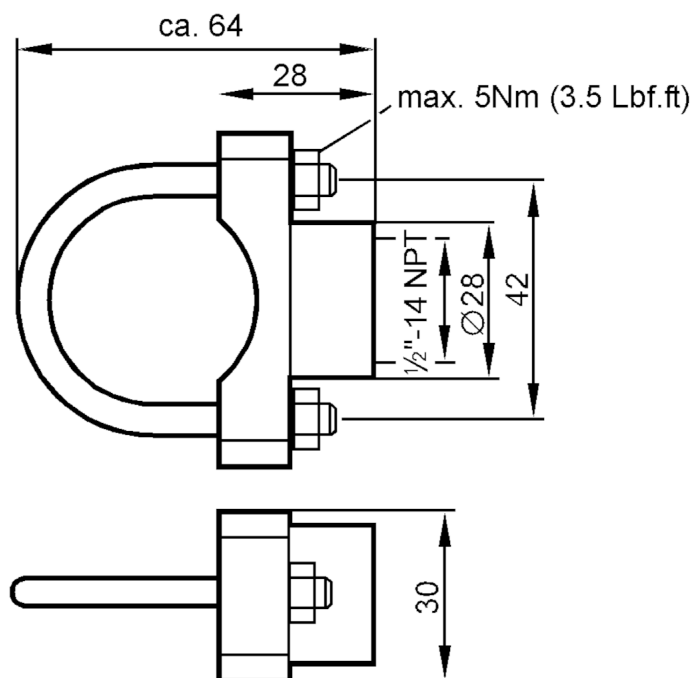

1 Sealing

Application

Design for protective tube with coupling, For pressure sensors with lateral connector, 1/2 - 14 NPT

Mechanical data

Weight [g] 215

Materials Clamping device: stainless steel (303/1.4305); clamp: stainless steel (304/1.4301); Sealing: FPM 75 Shore A

Remarks

Pack quantity 1 pcs.