

E20233



Fibre optic through beam sensor

FE-30-A-A-R6/1M

Article no longer available - archive entry

Alternative article: E20339 When selecting an alternative article and accessories please note that technical data may differ! – When selecting an alternative article and accessories please note that technical data may differ!

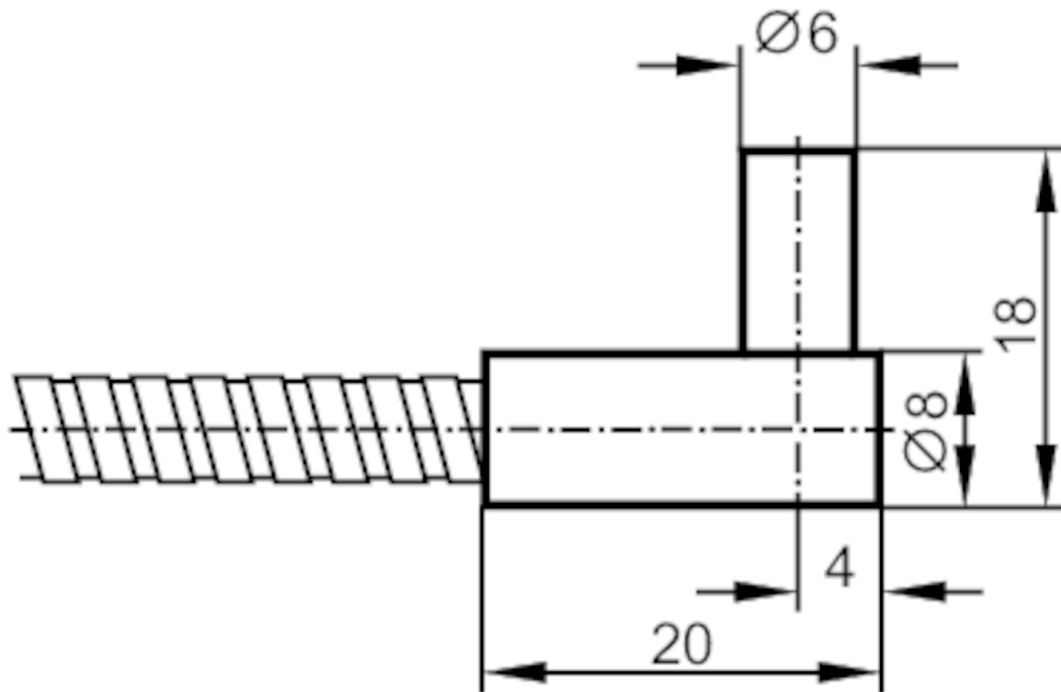

| Application | |
|---------------------------------------|---------------------|
| Function principle | Through-beam sensor |
| Detection zone | |
| Range with fibre optic amplifier type | OIF |
| OIF | |
| Range of fibre optics [mm] | 300 |
| Operating conditions | |
| Ambient temperature [°C] | -40...290 |
| Mechanical data | |
| Version of sensing head | angled |
| Total length [mm] | 1000 |
| Min. bending radius [mm] | 30 |
| Materials | Adapter: PA |
| Fibre material | glass |
| Fibre head material | aluminium |
| Fibre sheath material | aluminium |

E20233



Fibre optic through beam sensor

FE-30-A-A-R6/1M

Remarks

Pack quantity

1 pcs.

Article no longer available - archive entry

Alternative article: E20339 When selecting an alternative article and accessories please note that technical data may differ! – When selecting an alternative article and accessories please note that technical data may differ!