

E20163



Fibre optic through-beam sensor

FE-30-A-A-R3

Article no longer available - archive entry

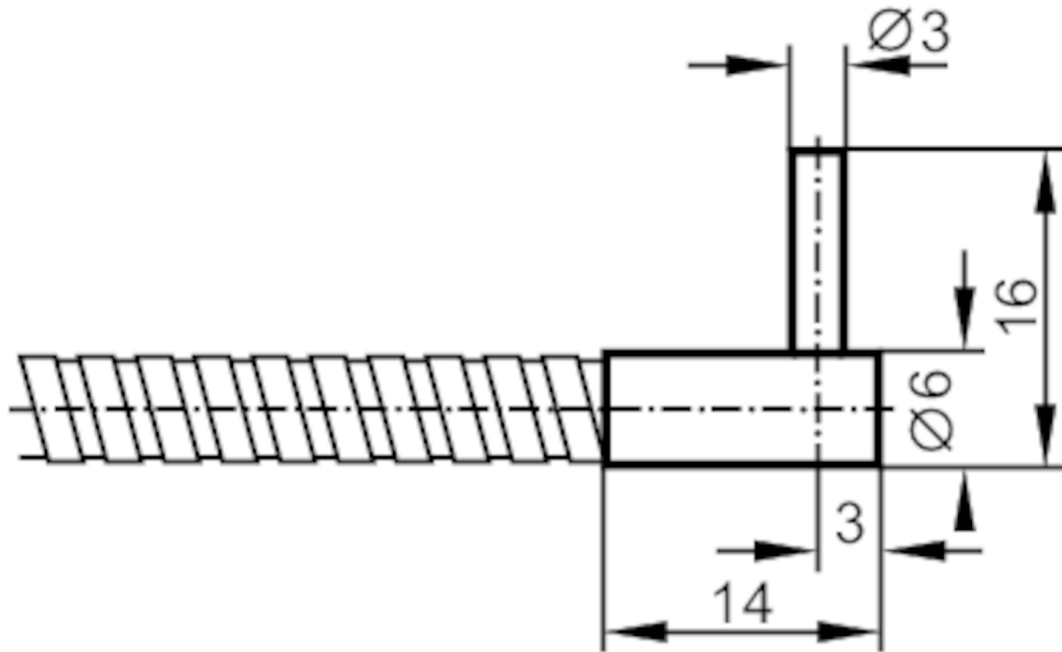

Application

Function principle Through-beam sensor

Detection zone

Range with fibre-optic amplifier type OIF

OIF

Range of fibre optics [mm] 100

Operating conditions

Ambient temperature [°C] -40...290

Mechanical data

Weight [g]	88.4
Version of sensing head	angled
Sensing head diameter [mm]	3
Total length [mm]	600
Min. bending radius [mm]	30; (for fixed installation)
Fibre arrangement	
Materials	Adapter: PA
Fibre material	glass
Fibre head material	aluminium

E20163



Fibre optic through-beam sensor

FE-30-A-A-R3

Fibre sheath material	aluminium
Accessories	
Items supplied	E20103
Remarks	
Pack quantity	1 pcs.