

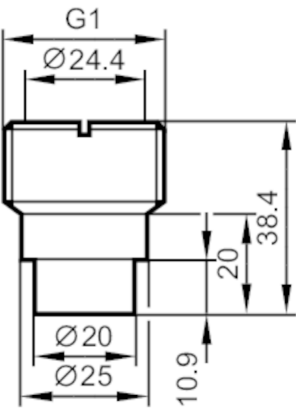

Mounting adapter for compressed air meter

ADTR, SD, WELD, 0.430" SHLDR



Application	
Design	for compressed air meters SD
Installation	for pipe sizes; (5" - 6" sch 80 / 80S, 10" sch 40 / 40S)
Mechanical data	
Weight [g]	113.398
Type of mounting	for pipe sizes; (5" - 6" sch 80 / 80S, 10" sch 40 / 40S)
Materials	stainless steel (316L/1.4404)
Remarks	
Pack quantity	1 pcs.