

## Flow sensor for connection to an evaluation unit

SFR12ZBB/10M

Article no longer available - archive entry

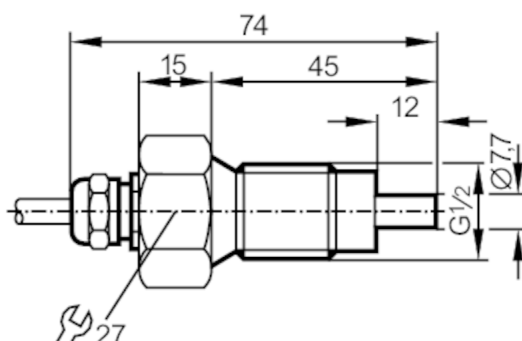

## Product characteristics

Process connection	G 1/2 external thread
--------------------	-----------------------

## Application

Application	high-temperature range
Media	Liquids; Gases
Pressure rating [bar]	30

## Liquids

Application	high-temperature range
Medium temperature [°C]	0...120

## Gases

Medium temperature [°C]	0...100
-------------------------	---------

## Electrical data

Connection to control monitor	VS 0200
-------------------------------	---------

## Measuring/setting range

## Liquids

Setting range [cm/s]	3...300
Greatest sensitivity [cm/s]	3...60

## Gases

Setting range [cm/s]	200...2000
Greatest sensitivity [cm/s]	200...800

## Accuracy / deviations

Temperature gradient [K/min]	15
------------------------------	----

## Response times

Response time [s]	1...10
-------------------	--------

## Liquids

Response time [s]	1...10
-------------------	--------

## Gases

Response time [s]	1...10
-------------------	--------

## Operating conditions

Protection	IP 67
------------	-------

# SF3302



## Flow sensor for connection to an evaluation unit

SFR12ZBB/10M

Mechanical data	
Housing	threaded type
Materials	stainless steel (316Ti/1.4571)
Materials (wetted parts)	stainless steel (316Ti/1.4571)
Process connection	G 1/2 external thread
Accessories	
Items supplied	sealings: 2 x AMF 30
Remarks	
Pack quantity	1 pcs.
Electrical connection	
Cable: 10 m; 5 x 0.34 mm <sup>2</sup>	
Connection	

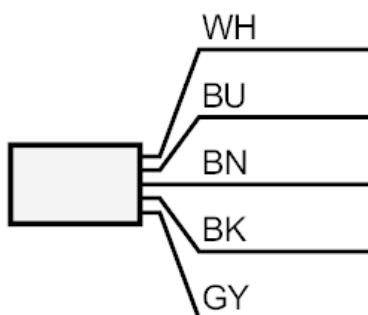

	Core colours :
BN =	brown
BU =	blue
BK =	black
WH =	white
GY =	grey