

## Connecting cable with socket

ADOAH040MSS0020C04

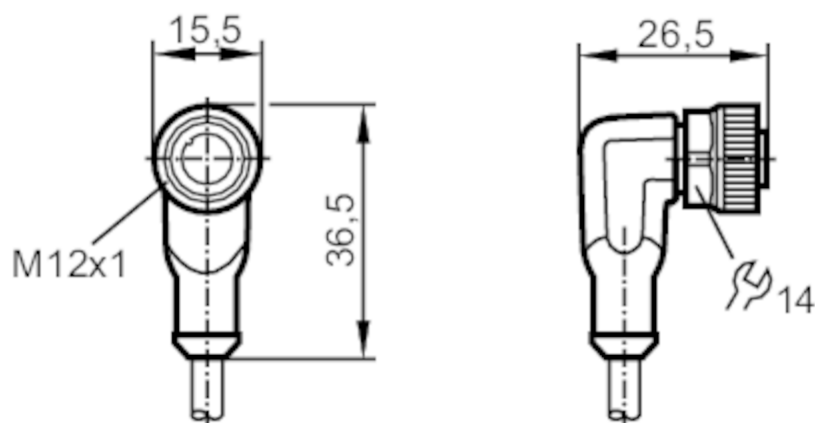

## Application

|                    |  |
|--------------------|--|
| Special feature    | Free from silicone; Halogen-free; Gold-plated contacts; Screened cable; Drag chain suitability |
| Free from silicone | yes  |

## Electrical data

|                         |     |                   |
|-------------------------|-----|-------------------|
| Operating voltage       | [V] | < 50 AC / < 60 DC |
| Protection class        |     | III               |
| Max. current load total | [A] | 4                 |

## Operating conditions

|                                      |      |                             |
|--------------------------------------|------|-----------------------------|
| Ambient temperature                  | [°C] | -25...90                    |
| Note on ambient temperature          |      | cULus: ...75                |
| Ambient temperature (moving)         | [°C] | -25...90                    |
| Note on ambient temperature (moving) |      | cULus: ...75                |
| Protection                           |      | IP 65; IP 67; IP 68; IP 69K |

## Mechanical data

|                        |      |                                   |
|------------------------|------|-----------------------------------|
| Weight                 | [g]  | 793                               |
| Dimensions             | [mm] | 26.5 x 15.5 x 36.5                |
| Materials              |      | housing: TPU orange; Sealing: FKM |
| Material nut           |      | brass, nickel-plated              |
| Drag chain suitability |      | yes                               |



Connecting cable with socket

ADOAH040MSS0020C04

|                        |                                 |  |
|------------------------|---------------------------------|--|
| Drag chain suitability | bending radius for flexible use | min. 10 x cable diameter   |
|                        | travel speed                    | max. 3.3 m/s for a horizontal travel length of 5 m and max. acceleration of 5 m/s <sup>2</sup> |
|                        | bending cycles                  | ≥ 2 Mio.   |
|                        | torsional strain                | ± 180 °/m  |

Remarks

|               |        |
|---------------|--------|
| Pack quantity | 1 pcs. |
|---------------|--------|

Electrical connection

Cable: 20 m, PUR, Halogen-free, black, Ø 4.9 mm, shielded; 4 x 0.34 mm<sup>2</sup> (42 x Ø 0.1 mm )

Electrical connection - socket

Connector: 1 x M12, angled; coding: A; Locking: brass, nickel-plated; Contacts: gold-plated; Tightening torque: 0.6...1.5 Nm;  
Shielded connection cable: screen not connected



Connection

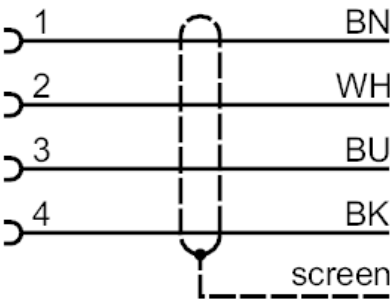

|      |                |
|------|----------------|
|      | Core colours : |
| BK = | black          |
| BN = | brown          |
| BU = | blue           |
| WH = | white          |