



Temperature sensor with process connection

TM-045-BTM18

/US

phase-out article

Alternative articles: TM9950

When selecting an alternative article and accessories please note that technical data may differ!

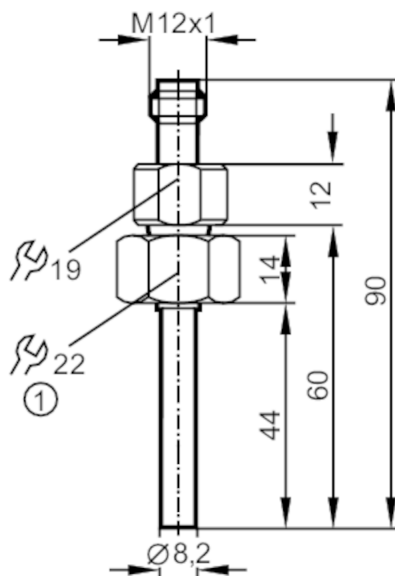

1 internal thread M18 x 1.5



Product characteristics

Measuring range	-40...125 °C	-40...257 °F
Process connection	threaded connection M18 x 1,5 internal thread	
Installation length EL [mm]	60	

Application

Special feature	Gold-plated contacts	
Measuring element	1 x Pt 100; (to DIN EN 60751, class B)	
Media	liquids and gases	
Pressure rating [bar]	300	
Minimum installation depth [mm]	15	

Electrical data

Protection class	III
------------------	-----

Measuring/setting range

Probe length L	[mm]	44	
Measuring range		-40...125 °C	-40...257 °F

Accuracy / deviations

Accuracy [K]	± (0,30 K + 0,005 x t)
--------------	-------------------------

Response times

Dynamic response T05 / T09 [s]	1 / 3; (to DIN EN 60751)
--------------------------------	--------------------------

Operating conditions

Ambient temperature [°C]	-25...80
--------------------------	----------

TM9900



Temperature sensor with process connection

TM-045-BTM18

/US

Storage temperature	[°C]	-40...100
Protection		IP 68; IP 69K

Tests / approvals

MTTF	[years]	22831
------	---------	-------

Mechanical data

Weight	[g]	66.8
Materials		stainless steel (316L/1.4404)
Materials (wetted parts)		titanium (3.7035)
Process connection		threaded connection M18 x 1,5 internal thread
Probe diameter	[mm]	8.2
Installation length EL	[mm]	60

Remarks

Remarks	operating voltage "supply class 2" according to cULus The values for accuracy apply to flowing water.
Pack quantity	1 pcs.

Electrical connection

Connector: 1 x M12; coding: A; Contacts: gold-plated



Connection

