

E30135

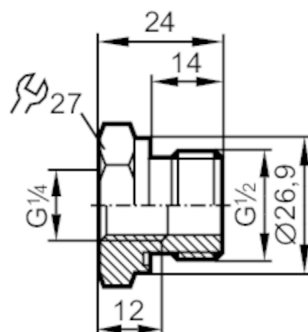

Screw-in adapter for process sensors

ADAPT G1/4 I - G1/2 A



Application

Pressure rating [bar] 400

Tests / approvals

Pressure Equipment Directive

A possible classification to PED depends on the application and has to be carried out by the user / operator.

Safety instructions

The compatibility between medium and product material has to be checked in all applications.

Mechanical data

Weight [g] 61.8

Materials stainless steel (316Ti/1.4571); Sealing: FKM

Sensor connection G 1/4 external thread

Process connection threaded connection G 1/2

Remarks

Pack quantity 1 pcs.