

DN0220

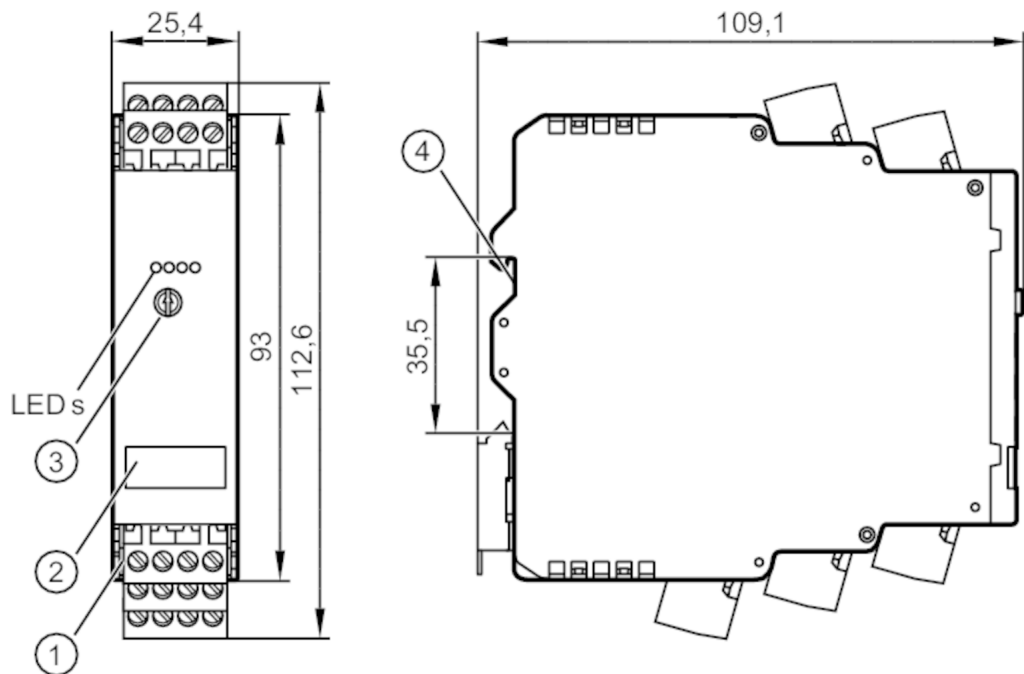

Switching amplifier

N200/SA-2 110-240VAC



- 1 plug-in screw terminals
- 2 panel for labelling
- 3 potentiometer
- 4 mounting on DIN rail



Product characteristics

Housing	housing for DIN rail mounting
---------	-------------------------------

Application

Application	Power supply and signal evaluation
-------------	------------------------------------

Electrical data

Nominal voltage AC	[V]	110...240
Nominal voltage tolerance	[%]	> 20
Nominal voltage tolerance 2	[%]	20...10
Nominal frequency AC	[Hz]	50...60
Insulation rating	[V]	9
Max. power consumption AC	[W]	11
Auxiliary energy for sensors DC	[V]	24; (SELV, $\pm 10\%$, $2 \times \leq 150\text{ mA}$)
Number of channels		2

Inputs / outputs

Number of inputs and outputs	Number of relay outputs: 2
------------------------------	----------------------------

Inputs

Input circuit of digital inputs	PNP/NPN
---------------------------------	---------

Outputs

Number of relay outputs	2
-------------------------	---

DN0220



Switching amplifier

N200/SA-2 110-240VAC

Contact rating	4 A (240 V AC, 24 V DC); (ohmic resistance)	
Operating conditions		
Ambient temperature	[°C]	-20...60
Storage temperature	[°C]	-25...70
Max. relative air humidity	[%]	80; (40 °C: 50 % non condensing)
Max. height above sea level	[m]	3000
Protection		IP 20
Protection rating terminals		IP 20
Pollution degree		2; (≤ 240 V AC)
Tests / approvals		
MTTF	[years]	215
Mechanical data		
Weight	[g]	240.5
Housing		housing for DIN rail mounting
Type of mounting		rail; (TH35 EN 60715)
Materials		plastics: PC-GF20
Displays / operating elements		
Display	power supply	1 x LED, green
	Output	2 x LED, yellow
	errors	1 x LED, red
Accessories		
Items supplied	connector: 5 x 4-pole, with screw connection, E40173	

Switching amplifier

N200/SA-2 110-240VAC

Electrical connection

pin headers: 4 x ; Spacing: 5.0 mm

Connection

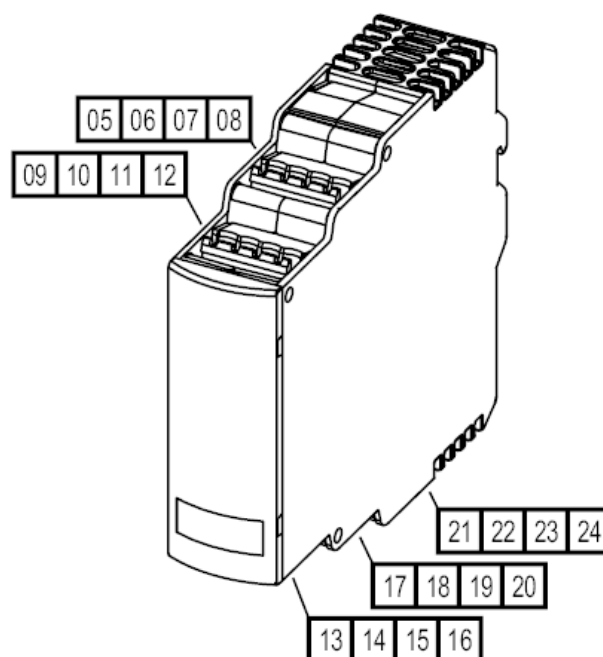

05	relay 1 normally open
06	relay 1 common
07	relay 1 common
08	relay 1 normally closed
09	DC Sensor supply 1 (+)
10	sensor signal 1 pnp/npn
11	not used
12	DC Sensor supply 1 (-)
13	DC Sensor supply 2 (+)
14	sensor signal 2 pnp/npn
15	not used
16	DC Sensor supply 2 (-)
17	relay 2 normally open
18	relay 2 common
19	relay 2 common
20	relay 2 normally closed
21	AC supply voltage (L)
22	AC supply voltage (L)
23	AC supply voltage (N)
24	AC supply voltage (N)