

External illumination

Dome Light 80 CY RD/ US

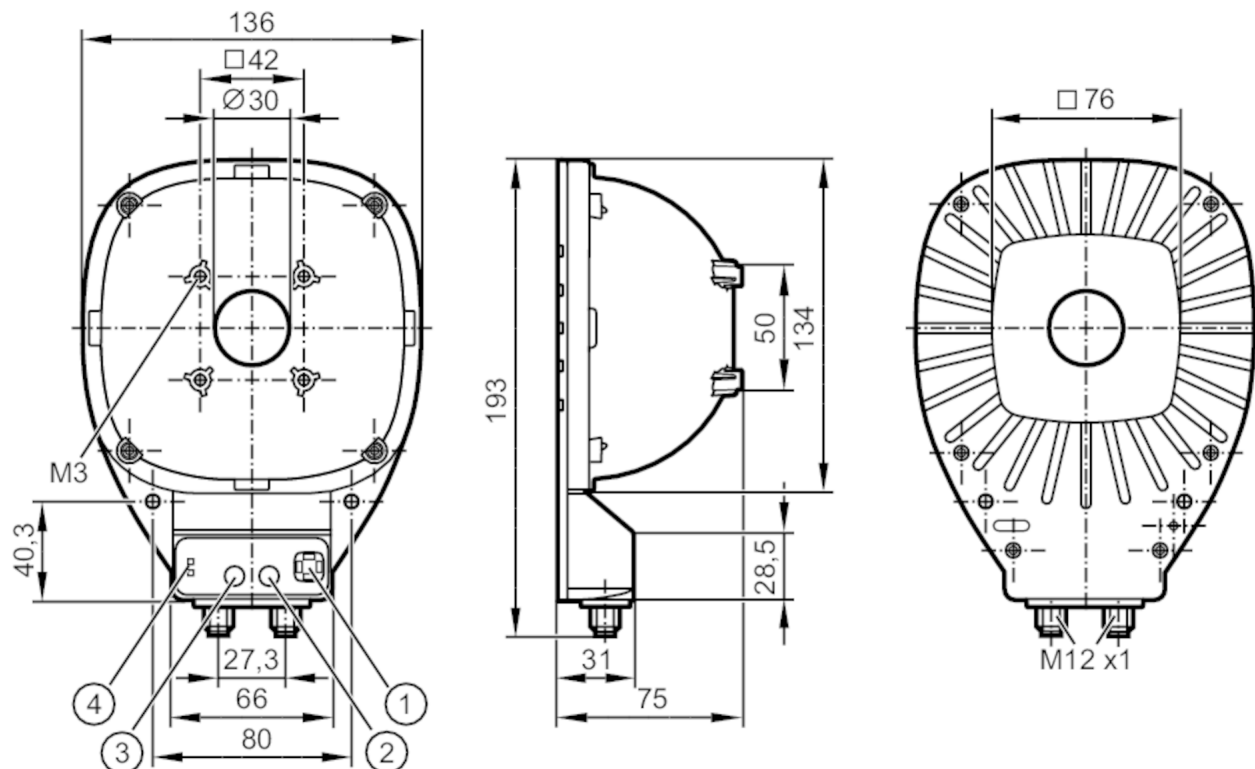

- 1 LED segment
- 2 pushbutton Segment
- 3 pushbutton Colour
- 4 LED operating status



Product characteristics

Type of light	red light; cyan light
---------------	-----------------------

Application

Illuminated field [mm]	80 x 80
Design	Dome
Type of operation	normal light intensity (permanent operation possible); High light intensity (pulsed)

Electrical data

Operating voltage [V]	24 DC
Current consumption [mA]	operating mode "permanent operation": 375; operating mode "high light intensity": 2130
Protection class	III; (PELV)
Type of light	red light; cyan light

Inputs / outputs

Number of inputs and outputs	Number of digital inputs: 1
------------------------------	-----------------------------

Inputs

Trigger	24 V PNP/NPN; external
Number of digital inputs	1

Operating conditions

Ambient temperature [°C]	-10...40
--------------------------	----------



External illumination

Dome Light 80 CY RD/ US

Storage temperature	[°C]	-20...60
Protection		IP 65

Tests / approvals

Photobiological safety	risk group 1; (DIN EN 62471)
------------------------	------------------------------

Mechanical data

Weight	[g]	512.05
Dimensions	[mm]	193 x 136 x 75
Materials		housing: aluminium black anodised; Cover: ABS
Tightening torque	[Nm]	0.5...1.5

Displays / operating elements

Display	operation	1 x LED, green
	operating mode "high light intensity"	1 x LED, red
	LED segment	1 x LED, white

Remarks

Pack quantity	1 pcs.
---------------	--------

Electrical connection - parameter setting

Connector: M12; coding: A

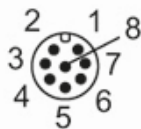

- 1: operating mode "high light intensity"
- 2: colour 2
- 3: GND
- 4: LED segment 1
- 5: LED segment 2
- 6: LED segment 3
- 7: LED segment 4
- 8: deactivate buttons

Electrical connection - power supply

Connector: M12; coding: A

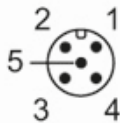

- 1: U+
- 2: trigger input NPN
- 3: GND
- 4: trigger input PNP
- 5: dimmer