

E11890

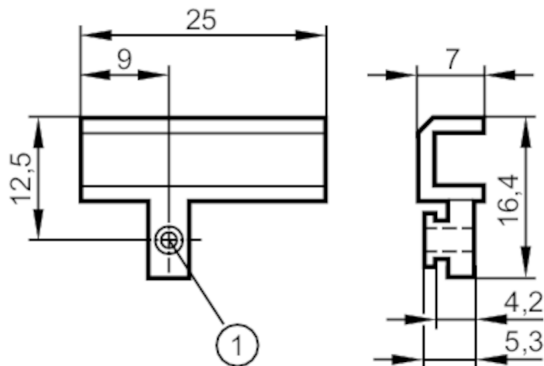

Mounting adapter for SMC pneumatic cylinders

ADAPT FOR CYL SMC ECDQ2



1 Mounting screw SW 1.5

Application	
Design	T-slot rail, flat, for types, MKT
Mechanical data	
Weight [g]	3.7
Type of mounting	for series: SMC ECDQ2
Dimensions [mm]	16.4 x 25 x 7
Materials	Adapter: aluminium; screw: stainless steel
Remarks	
Pack quantity	1 pcs.