

E10536



Connecting cable with socket

ADOAF030MSS0002E03

Article no longer available - archive entry

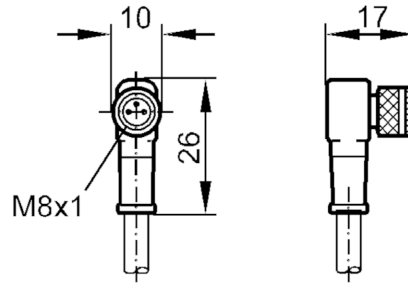

Electrical data

| | | |
|-------------------|-----|-------------------|
| Operating voltage | [V] | < 60 AC / < 75 DC |
| Protection class | | III |

Operating conditions

| | | |
|---------------------|------|------------------------|
| Ambient temperature | [°C] | -25...90 |
| Protection | | IP 67; (if screwed on) |

Mechanical data

| | | |
|--------------|------|----------------------|
| Dimensions | [mm] | 17 x 10 x 26 |
| Materials | | TPU |
| Material nut | | brass, nickel-plated |

Remarks

| | | |
|---------------|--|--------|
| Pack quantity | | 1 pcs. |
|---------------|--|--------|

Electrical connection

Cable: 2 m, PVC, orange, Ø 5 mm; 3 x 0.34 mm² (42 x Ø 0.1 mm)

Electrical connection - socket

Connector: 1 x M8, angled; Moulded body: TPU; Locking: brass, nickel-plated

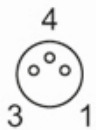

E10536



Connecting cable with socket

ADOAF030MSS0002E03

Connection

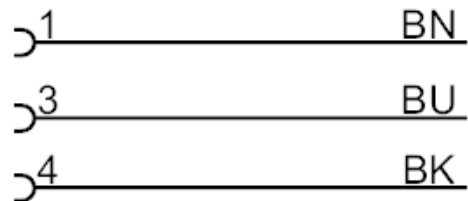

Core colours :

BK = black
BN = brown
BU = blue

Article no longer available - archive entry