

DN2134



Switched-mode power supply 24 V DC

POWER SUPPLY/24VDC/20A

discontinued article
replaced by: DN4034

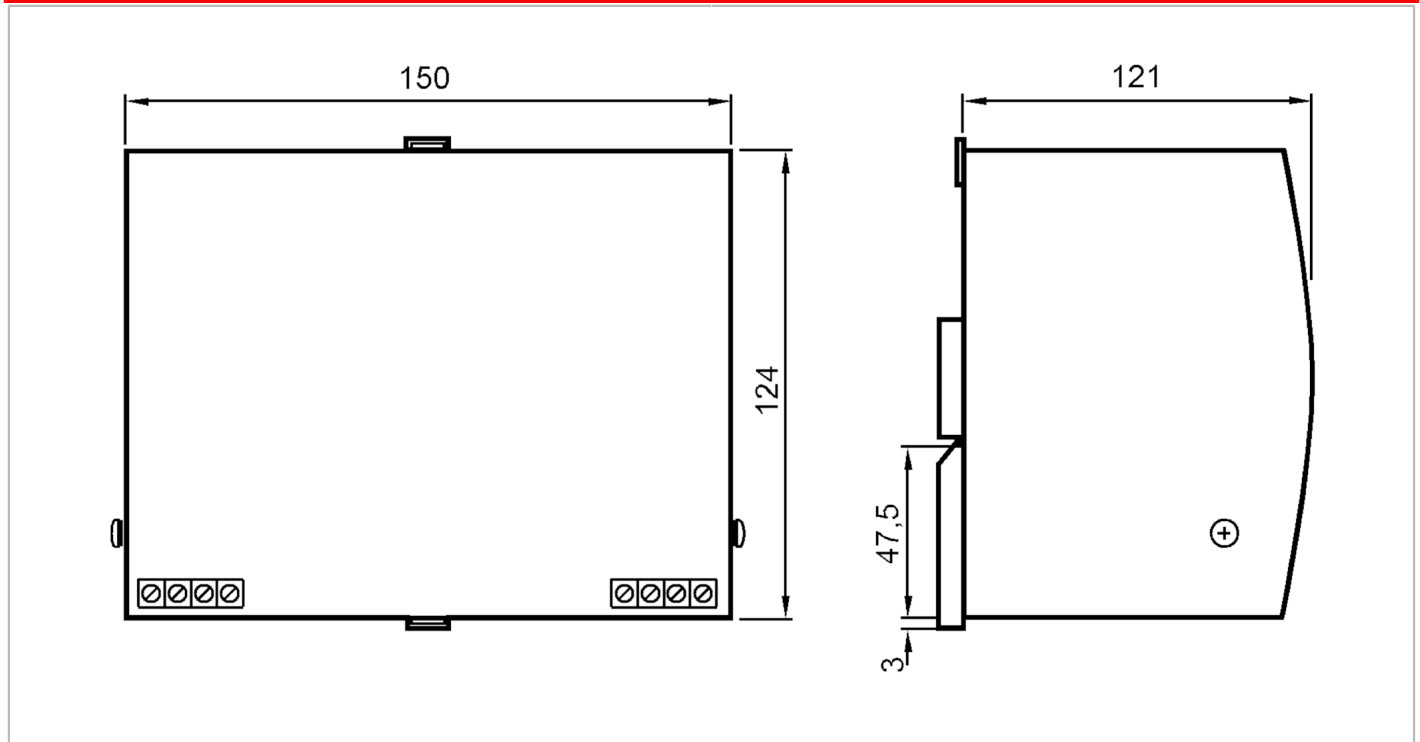

Electrical data		
Nominal voltage AC	[V]	400...500
Nominal frequency AC	[Hz]	47...63
Input voltage DC	[V]	450...820
Input voltage range AC	[V]	340...576
Output voltage DC	[V]	24...28
Protection class		I; (IEC 61140)
Max. power-on delay time	[ms]	80
Power-on delay time	[s]	< 80
Output voltage	[V]	adjustable
Output voltage tolerance	[%]	2
Max. output current at min. output voltage	[A]	20
Number of output circuits		1
Max. residual ripple	[%]	0.1
Derating	[W/K]	12 (60...70 °C)
Outputs		
Short-circuit protection		yes
Overload protection		yes

DN2134



Switched-mode power supply 24 V DC

POWER SUPPLY/24VDC/20A

Operating conditions		
Ambient temperature [°C]	0...70	
Protection	IP 20	
Tests / approvals		
EMC	EN 50081-1	
	EN 61000-6-2	
	EN 61000-3-2	
MTTF [years]	58	
Mechanical data		
Weight [g]	1810.6	
Type of mounting	rail; (TH35 (EN 60715))	
Materials	aluminium	
Displays / operating elements		
Display	Output voltage	LED, green
	overload	LED, red
	short circuit	LED, red flashing
Remarks		
Pack quantity	1 pcs.	
Electrical connection		
terminals: 1.5...6 mm ²		
Connection		

discontinued article

replaced by: DN4034