

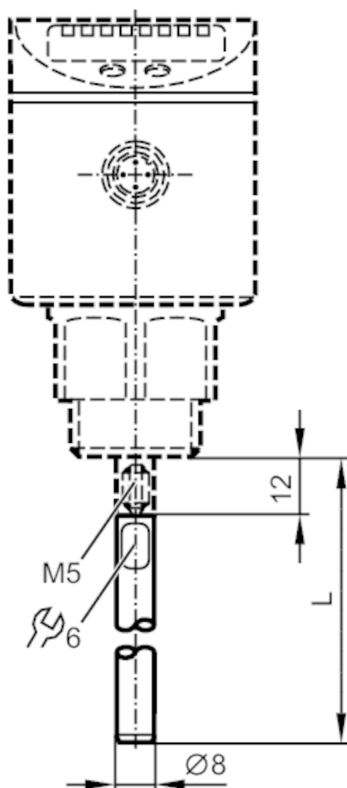

## Probe for level sensors

LR PROBE L700



## Application

Design	for level sensors LR
--------	----------------------

## Measuring/setting range

Probe length L	[mm]	700
----------------	------	-----

## Mechanical data

Weight	[g]	300
Materials	stainless steel (316L/1.4404)	
Tightening torque	[Nm]	4

## Remarks

Pack quantity	1 pcs.
---------------	--------