

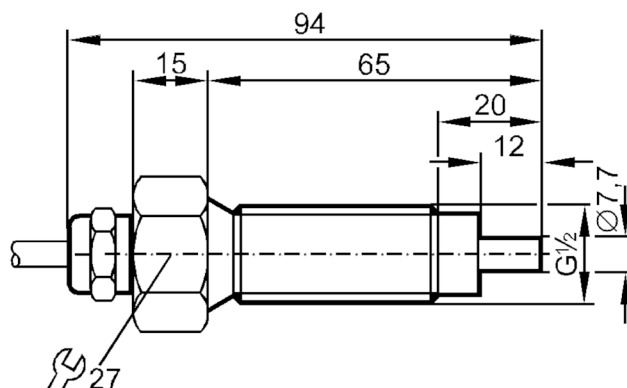

Flow sensor for connection to an evaluation unit

SFR12ABT

Article no longer available - archive entry



Product characteristics

Process connection	G 1/2 external thread
--------------------	-----------------------

Application

Media	Liquids; Gases; aggressive media
-------	----------------------------------

Medium temperature	[°C]	-25...80
--------------------	------	----------

Pressure rating	[bar]	30
-----------------	-------	----

Liquids

Medium temperature	[°C]	-25...80
--------------------	------	----------

Gases

Medium temperature	[°C]	-25...80
--------------------	------	----------

Electrical data

Connection to control monitor	VS 0200
-------------------------------	---------

Measuring/setting range

Liquids

Setting range	[cm/s]	3...300
---------------	--------	---------

Greatest sensitivity	[cm/s]	3...60
----------------------	--------	--------

Gases

Setting range	[cm/s]	200...2000
---------------	--------	------------

Accuracy / deviations

Temperature gradient	[K/min]	15
----------------------	---------	----

Response times

Response time	[s]	1...10
---------------	-----	--------

Liquids

Response time	[s]	1...10
---------------	-----	--------



Flow sensor for connection to an evaluation unit

SFR12ABT

Gases	
Response time	[s] 1...10
Operating conditions	
Protection	IP 67
Mechanical data	
Housing	threaded type
Materials	titanium (3.7235)
Materials (wetted parts)	titanium (3.7235)
Process connection	G 1/2 external thread
Accessories	
Items supplied	sealings: 2 x AMF 30
Remarks	
Pack quantity	1 pcs.
Electrical connection	
Cable: 2 m, PUR; Maximum cable length: 100 m; 5 x 0.34 mm ²	
Connection	

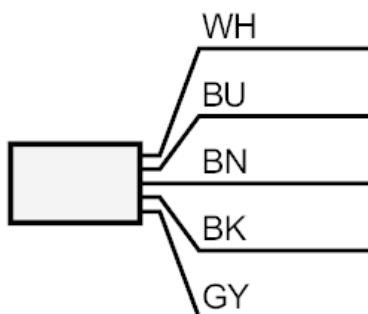

Core colours :

BN = brown
 BU = blue
 BK = black
 WH = white
 GY = grey