

# E12470

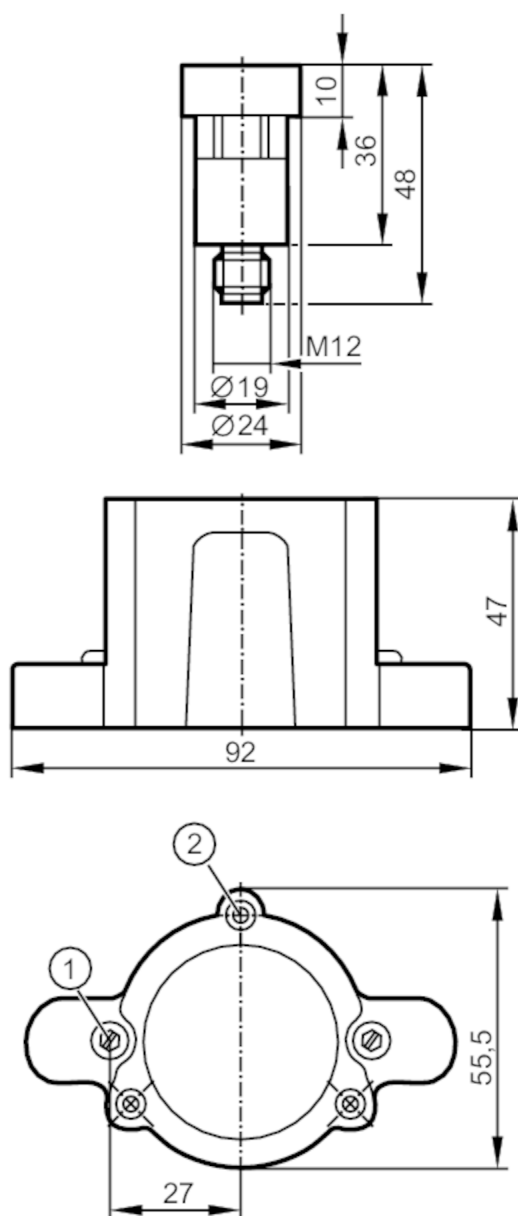

## Mounting adapter for position sensors used on rising stem valves

VALVIS ADAPTER 17



- 1 head cap screw M4 to fix the adapter on the valve
- 2 threaded hole M4 to fix the valve sensor on the adapter

### Application

Design for Alfa Laval valves Typ SSV (Single Seat Valves)

### Mechanical data

Weight [g] 182.5

Materials Adapter: PA 6; Target: stainless steel (316L/1.4404); screws: stainless steel (1.4301 / 304); Clamping device: stainless steel (1.4301 / 304)

### Remarks

Pack quantity 1 pcs.