

# VSE150

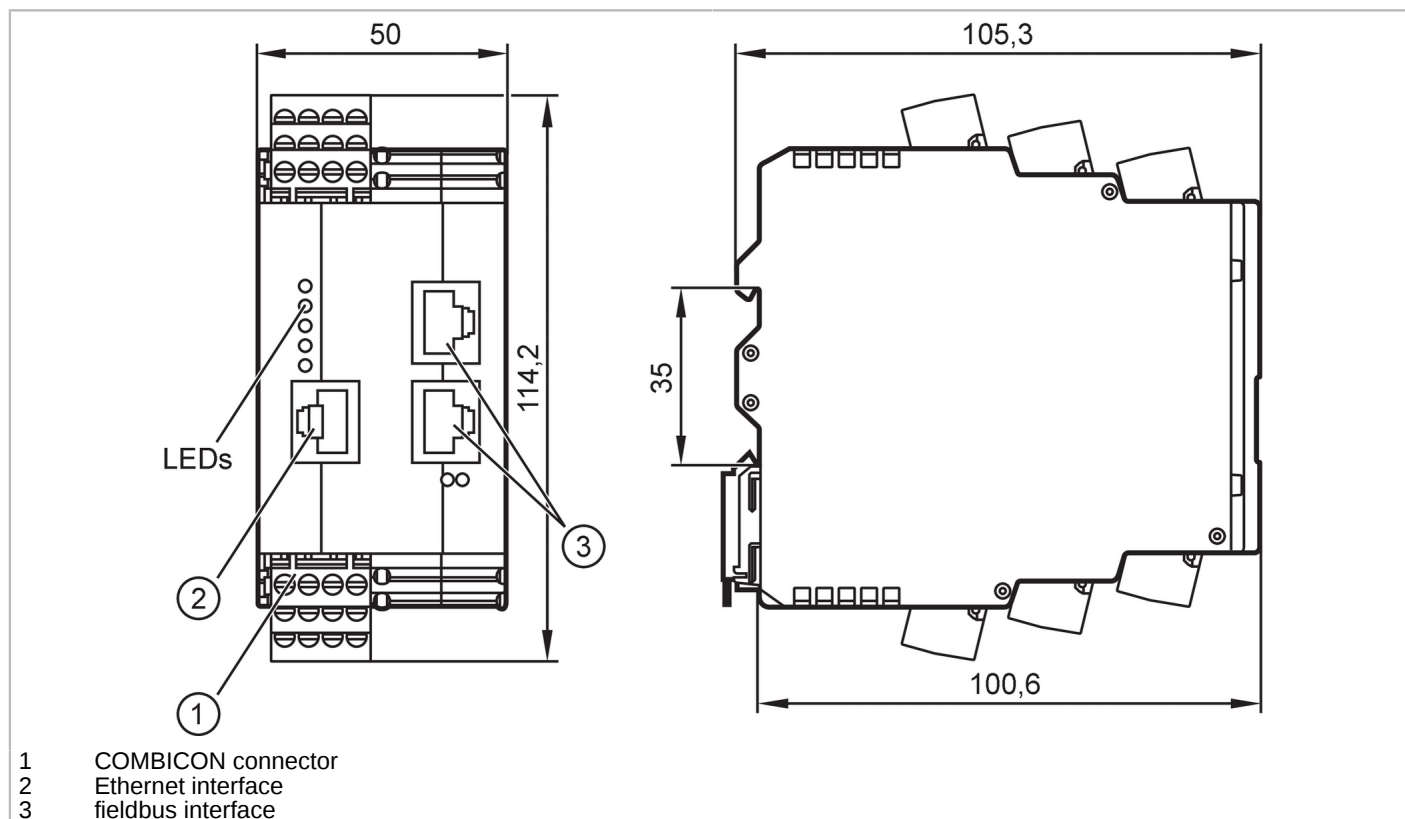

## Diagnostic electronics for vibration sensors

DIAGNOSTIC ELECTRONICS



Product characteristics	
Frequency range	[Hz] 0.1...12000
Communication interface	Ethernet
Application	
Design	housing for DIN rail mounting, parameter setting via PC software, VES004
Application	continuous vibration monitoring
Electrical data	
Operating voltage tolerance	[%] 20
Operating voltage	[V] 24 DC; (when using the IEPE input: 24 V + 20%; IEPE = Integrated Electronics Piezo Electric)
Current consumption	[mA] 200; ((24 V DC))
Protection class	III
Inputs / outputs	
Total number of inputs and outputs	8; (configurable)
Number of inputs and outputs	Number of analogue inputs: 2; number of dynamic inputs: 4; Number of digital outputs: 2; Number of analogue outputs: 1
Inputs	
Total number of inputs	6
Number of analogue inputs	2
Analogue input (current)	[mA] 4...20
Resolution of analogue input	12



## Diagnostic electronics for vibration sensors

### DIAGNOSTIC ELECTRONICS

Number of dynamic inputs	4
Dynamic input - signal	0...10 mA / IEPE / 4...20 mA
Dynamic input - resolution [bit]	16
Dynamic input - frequency range [Hz]	0,1...12000
Dynamic input - sampling rate [kSamples]	100

### Outputs

Total number of outputs	2
Output signal	switching signal; analogue signal
Electrical design	PNP
Number of digital outputs	2; (configurable)
Output function	normally open / normally closed; (parameterisable)
Max. voltage drop switching output DC [V]	2
Permanent current rating of switching output DC [mA]	100
Number of analogue outputs	1; (configurable)
Analogue current output [mA]	4...20
Max. load [Ω]	500
Short-circuit protection	yes
Type of short-circuit protection	pulsed
Overload protection	yes

### Measuring/setting range

Frequency range [Hz]	0.1...12000
----------------------	-------------

### Interfaces

Communication interface	Ethernet
Transmission rate	10 MBaud; 100 MBaud

### Ethernet - PROFINET

Protocol	PROFINET
----------	----------

### Ethernet Config

Protocol	TCP/IP
----------	--------

### Operating conditions

Ambient temperature [°C]	0...60
Storage temperature [°C]	0...60
Protection	IP 20

### Tests / approvals

EMC	EN 61000-4-2 ESD	4 kV contact discharge / 15 kV air discharge
	EN 61000-4-3	10 V/m (80...2700 MHz)
	EN 61000-4-4 Burst	4 kV capacitive coupling probe, earthed
	EN 61000-4-6	10 V 0,15...80 MHz
	EN 61000-6-4	industrial environments
MTTF [years]		92

# VSE150



## Diagnostic electronics for vibration sensors

DIAGNOSTIC ELECTRONICS

UL approval	Ta	0...60 °C
	Enclosure type	open Type
	power supply	Limited Voltage/Current
	UL approval no.	L001

Mechanical data		
Weight	[g]	415.2
Type of mounting		mounting on DIN rail; (TH35 (EN 60715))
Dimensions	[mm]	114.2 x 50 x 105.3
Materials		PA

Data memories	
Real-time clock	yes

Accessories	
Accessories (optional)	cross-over Ethernet patch cable for the direct connection to the PC

Remarks	
Pack quantity	1 pcs.

### Electrical connection

COMBICON:

Connection

