

OGS300

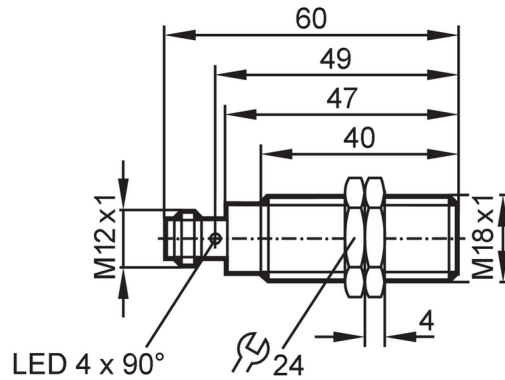

Through-beam sensor transmitter

OGS-00KG/US100



Product characteristics	
Type of light	red light
Housing	threaded type
Application	
Function principle	Through-beam sensor
Electrical data	
Operating voltage [V]	10...36 DC
Current consumption [mA]	15
Protection class	II
Reverse polarity protection	yes
Type of light	red light
Wave length [nm]	624
Detection zone	
Transmitter / receiver	transmitter
Range [m]	< 20
Range adjustable	no
Max. light spot diameter [mm]	800
Light spot dimensions refer to	at maximum range
Operating conditions	
Ambient temperature [°C]	-25...80
Protection	IP 65; IP 67; IP 68; IP 69K
Tests / approvals	
EMC	EN 60947-5-2
MTTF [years]	755
Mechanical data	
Weight [g]	59.4
Housing	threaded type
Dimensions [mm]	M18 x 1 / L = 60
Thread designation	M18 x 1
Materials	housing: stainless steel (316L/1.4404); Sealing: EPDM
Lens material	front pane:PMMA

OGS300



Through-beam sensor transmitter

OGS-00KG/US100

Displays / operating elements		
Display	operation	1 x LED, green
Accessories		
Items supplied		lock nuts: 2
Remarks		
Remarks		operating voltage "supply class 2" according to cULus
Pack quantity		1 pcs.

Electrical connection

Connector: 1 x M12; coding: A



Connection

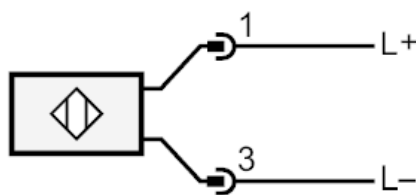

Diagrams and graphs

excess gain graph

