

# MS5010

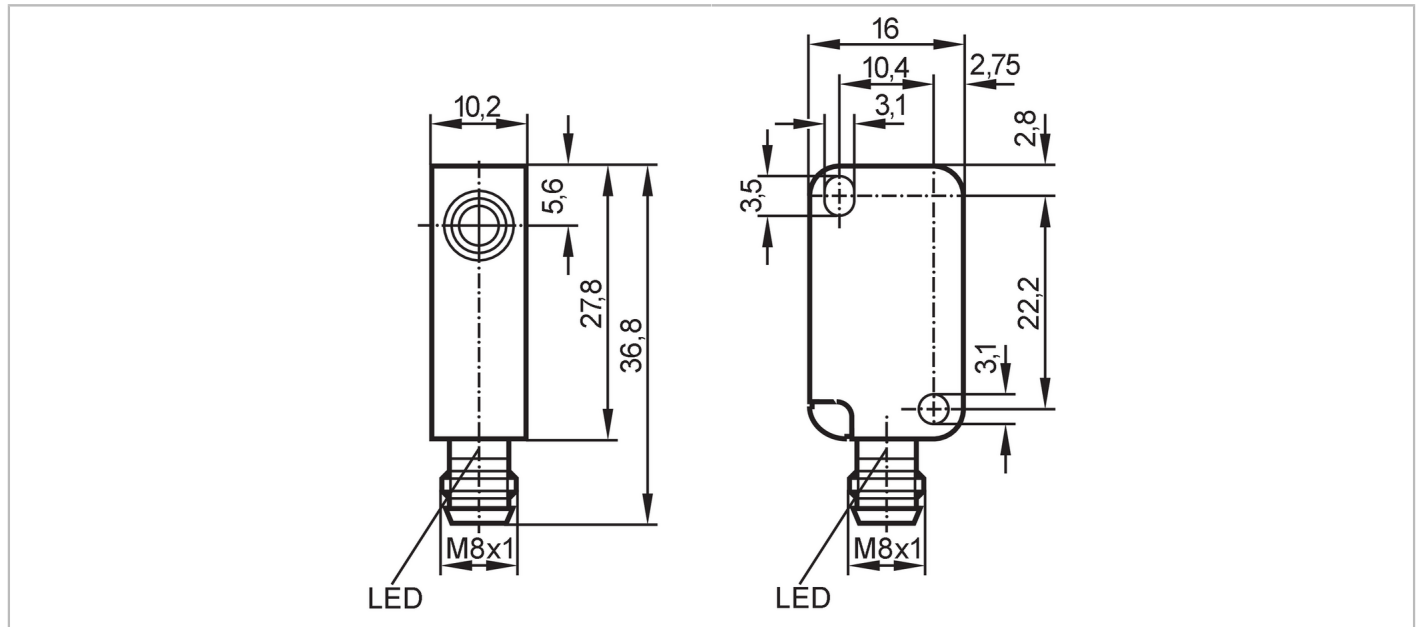

## Magnetic sensor

MS-3060-BPKG/AS-510-TPS



Product characteristics	
Electrical design	PNP
Output function	normally open
Sensing range [mm]	60; (referred to magnet M 4.0)
Housing	rectangular
Dimensions [mm]	36.8 x 10.2 x 16
Application	
Special feature	Gold-plated contacts
Electrical data	
Operating voltage [V]	10...30 DC; ("supply class 2" to cULus)
Current consumption [mA]	< 10
Protection class	III
Reverse polarity protection	yes
Outputs	
Electrical design	PNP
Output function	normally open
Max. voltage drop switching output DC [V]	2.5
Permanent current rating of switching output DC [mA]	200
Switching frequency DC [Hz]	5000
Short-circuit protection	yes
Type of short-circuit protection	pulsed
Overload protection	yes
Detection zone	
Sensing range [mm]	60; (referred to magnet M 4.0)

# MS5010



## Magnetic sensor

MS-3060-BPKG/AS-510-TPS

Response sensitivity	[mT]	1.2
----------------------	------	-----

### Accuracy / deviations

Hysteresis	[% of Sr]	1...10
------------	-----------	--------

### Operating conditions

Ambient temperature	[°C]	-25...75
---------------------	------	----------

Protection		IP 67
------------	--	-------

### Tests / approvals

EMC	EN 61000-4-2 ESD	4 kV CD / 8 kV AD
	EN 61000-4-3 HF radiated	10 V/m
	EN 61000-4-4 Burst	2 kV
	EN 61000-4-5 Surge	0,5 kV line to line, Ri: 2 Ohm
	EN 61000-4-6 HF conducted	10 V
	EN 55011	class B

MTTF	[years]	2847
------	---------	------

### Mechanical data

Weight	[g]	17
--------	-----	----

Housing		rectangular
---------	--	-------------

Dimensions	[mm]	36.8 x 10.2 x 16
------------	------	------------------

Materials		housing: PBT orange
-----------	--	---------------------

### Displays / operating elements

Display	switching status	1 x LED, yellow
---------	------------------	-----------------

### Remarks

Pack quantity		1 pcs.
---------------	--	--------

### Electrical connection - plug

Connector: 1 x M8; coding: A; Contacts: gold-plated



### Connection

