

# IS5026

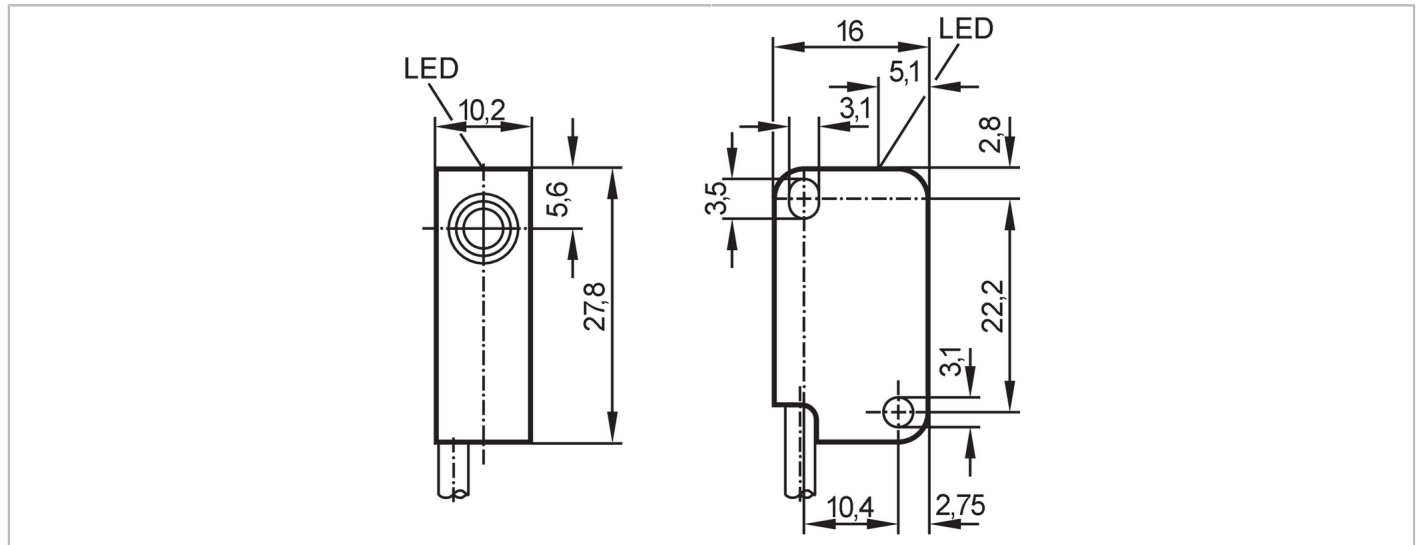

## Inductive sensor

IS-2002-FRKG/PH



Product characteristics	
Electrical design	PNP/NPN
Output function	normally open / normally closed; (selectable)
Sensing range [mm]	2
Housing	rectangular
Dimensions [mm]	27.8 x 10.2 x 16
Electrical data	
Operating voltage [V]	5...36 DC
Protection class	III
Reverse polarity protection	yes
Outputs	
Electrical design	PNP/NPN
Output function	normally open / normally closed; (selectable)
Max. voltage drop switching output DC [V]	4.6
Minimum load current [mA]	4
Max. leakage current [mA]	0.8
Permanent current rating of switching output DC [mA]	200
Switching frequency DC [Hz]	2000
Short-circuit protection	yes
Overload protection	yes
Detection zone	
Sensing range [mm]	2
Real sensing range $S_r$ [mm]	$2 \pm 10\%$
Operating distance [mm]	0...1.62
Accuracy / deviations	
Correction factor	steel: 1 / stainless steel: 0.7 / brass: 0.4 / aluminium: 0.3 / copper: 0.2

# IS5026



## Inductive sensor

IS-2002-FRKG/PH

Hysteresis	[% of Sr]	1...15
Switch point drift	[% of Sr]	-10...10

### Operating conditions

Ambient temperature	[°C]	-25...80
Protection		IP 67

### Tests / approvals

EMC	EN 61000-4-2 ESD	4 kV CD / 8 kV AD
	EN 61000-4-3 HF radiated	3 V/m
	EN 61000-4-4 Burst	2 kV
	EN 61000-4-6 HF conducted	3 V
	EN 55011	class B
MTTF	[years]	2460
UL approval	Ta	-25...75 °C
	Enclosure type	Type 1
	power supply	Limited Voltage/Current
	File number UL	E174191

### Mechanical data

Weight	[g]	38.9
Housing		rectangular
Mounting		flush mountable
Dimensions	[mm]	27.8 x 10.2 x 16
Materials		housing: PBT
Tightening torque	[Nm]	< 0.5; (with washer)

### Displays / operating elements

Display	switching status	1 x LED, yellow
---------	------------------	-----------------

### Remarks

Pack quantity		1 pcs.
---------------	--	--------

### Electrical connection

Cable: 2 m, PUR; 2 x 0.14 mm<sup>2</sup>

### Connection



Core colours :  
 BK = black  
 WH = white