

E33430

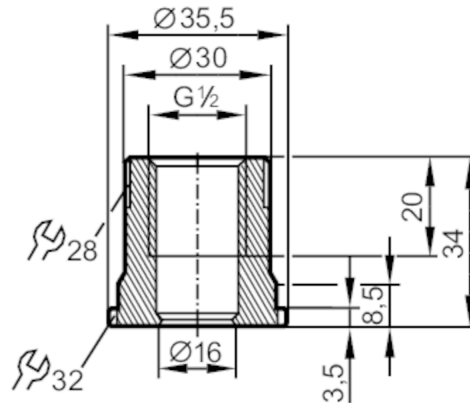

Process adapter for SMS pipe fitting

ADAPT G1/2-SMS DN25



EC 1935/2004 EHEDG Tested **FCM** **FDA**

Application

Pressure rating [bar] 40

Tests / approvals

Pressure Equipment Directive A possible classification to PED depends on the application and has to be carried out by the user / operator.

Safety instructions The compatibility between medium and product material has to be checked in all applications.

Mechanical data

Weight [g] 175

Materials stainless steel (316L/1.4435)

Sensor connection G 1/2 sealing cone

Process connection SMS pipe fitting DN25

Surface characteristics Ra/Rz of the wetted parts 0.4 / 4

Remarks

Pack quantity 1 pcs.