

# E20993

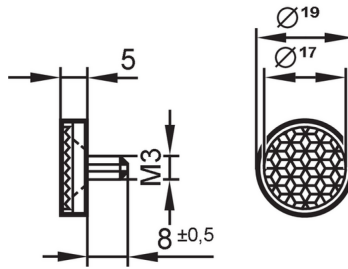

## Reflector for retro-reflective laser sensors

REFLECTOR LASER TS-19



1 M3 8 mm deep

### Application

Design round, for retro-reflective laser sensors, M3

### Operating conditions

Ambient temperature [°C] -10...60

### Mechanical data

Weight [g] 3

Dimensions [mm] Ø 19 / L = 5

Reflector surface [mm] Ø 17

Materials screw: stainless steel (316 / 1.4401); washer: stainless steel (316 / 1.4401); nut: stainless steel (316 / 1.4401); front panel: PMMA; base: ABS

### Remarks

Pack quantity 1 pcs.