

## Mounting set for photoelectric sensors

SYSTEM COMPONENT OJ BOLT

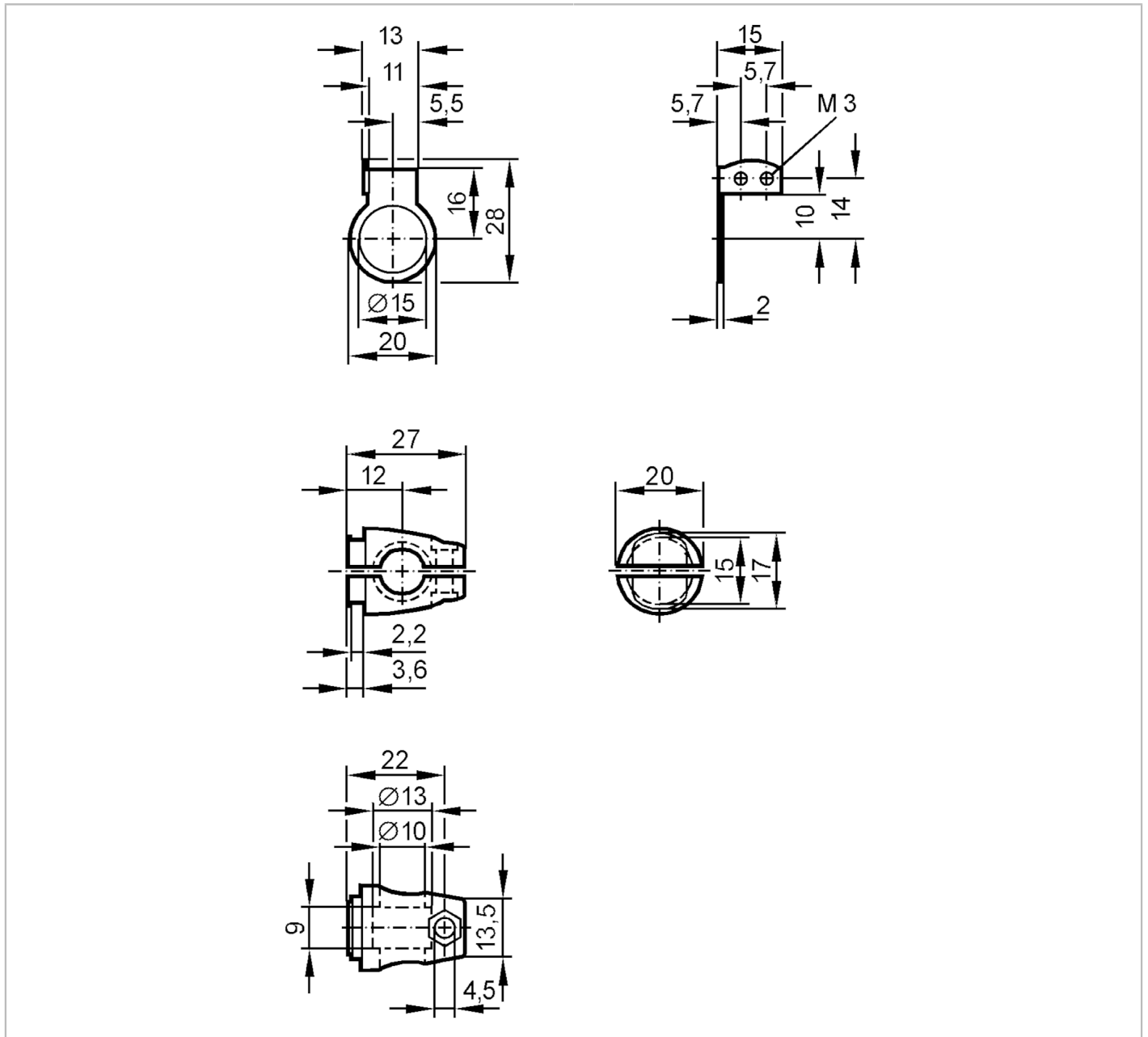

| Application      |  |
|------------------|--|
| Design           | clamp mounting, for front lens                               |
| Mechanical data  |  |
| Weight [g]       | 76   |
| Type of mounting | free-standing; (M8)  |
| Materials        | Clamp: diecast zinc; fixture: stainless steel (316Ti/1.4571) |
| Accessories      |  |
| Items supplied   | screw: 1 x (M8 x 40 mm)                                      |
| Remarks          |  |
| Pack quantity    | 1 pcs.   |