

E20870

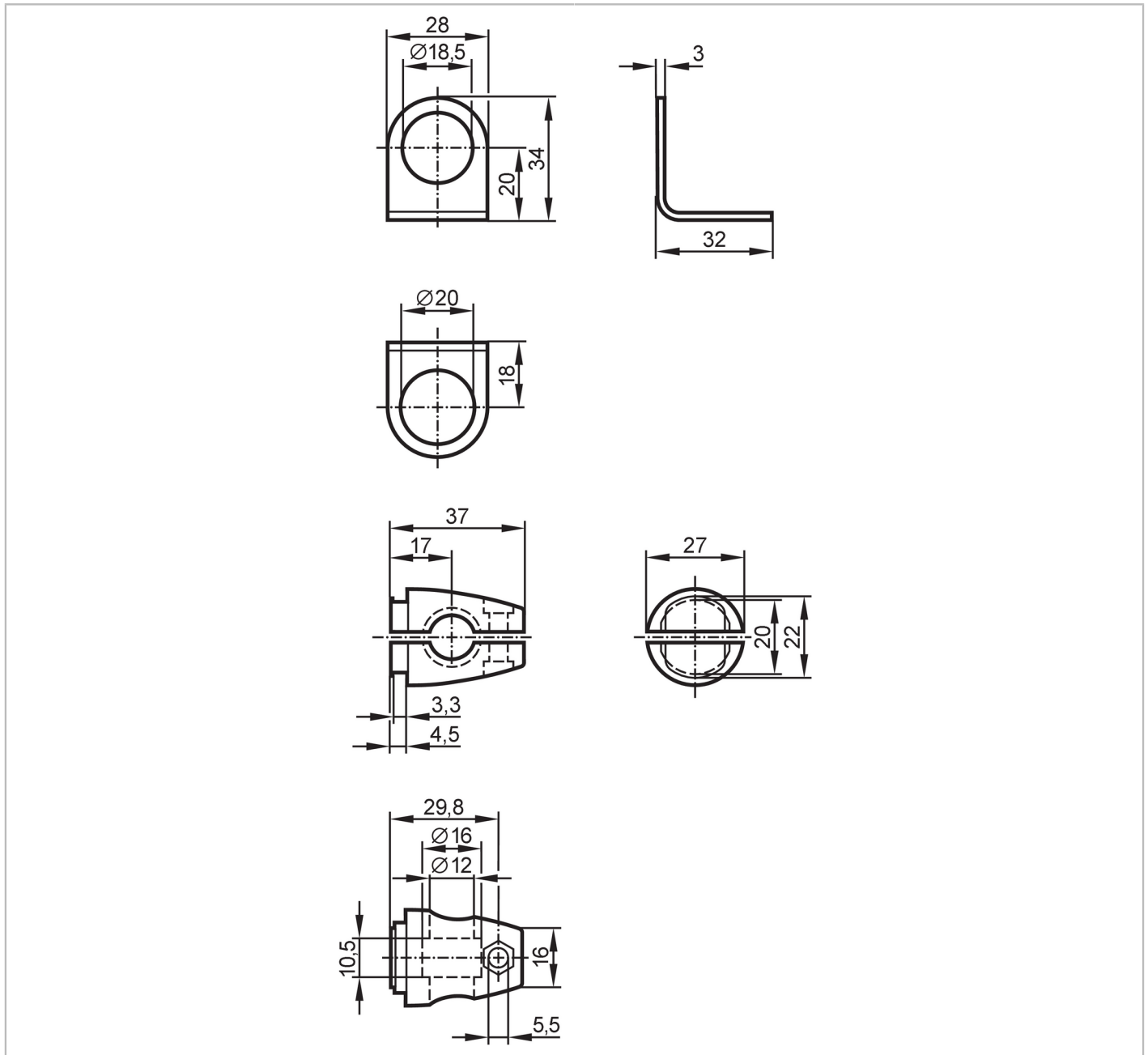

Mounting set for position sensors

SYSTEM COMPONENT M18 BOLT



Application	
Design	clamp mounting, for types, M18
Mechanical data	
Weight [g]	183.5
Type of mounting	free-standing; (M10)
Dimensions [mm]	$\varnothing 18.5$
Materials	fixture: stainless steel (316Ti/1.4571); Clamp: stainless steel (1.4408); head cap screw: stainless steel; washers: stainless steel; Nuts: stainless steel
Accessories	
Items supplied	head cap screw: 1 x (M10 x 55 mm)
	washers: 2 x ($\varnothing 10,5$ mm)
	Nuts: 2 x (M10)

E20870



Mounting set for position sensors

SYSTEM COMPONENT M18 BOLT

Remarks	
Pack quantity	1 pcs.