

E20856

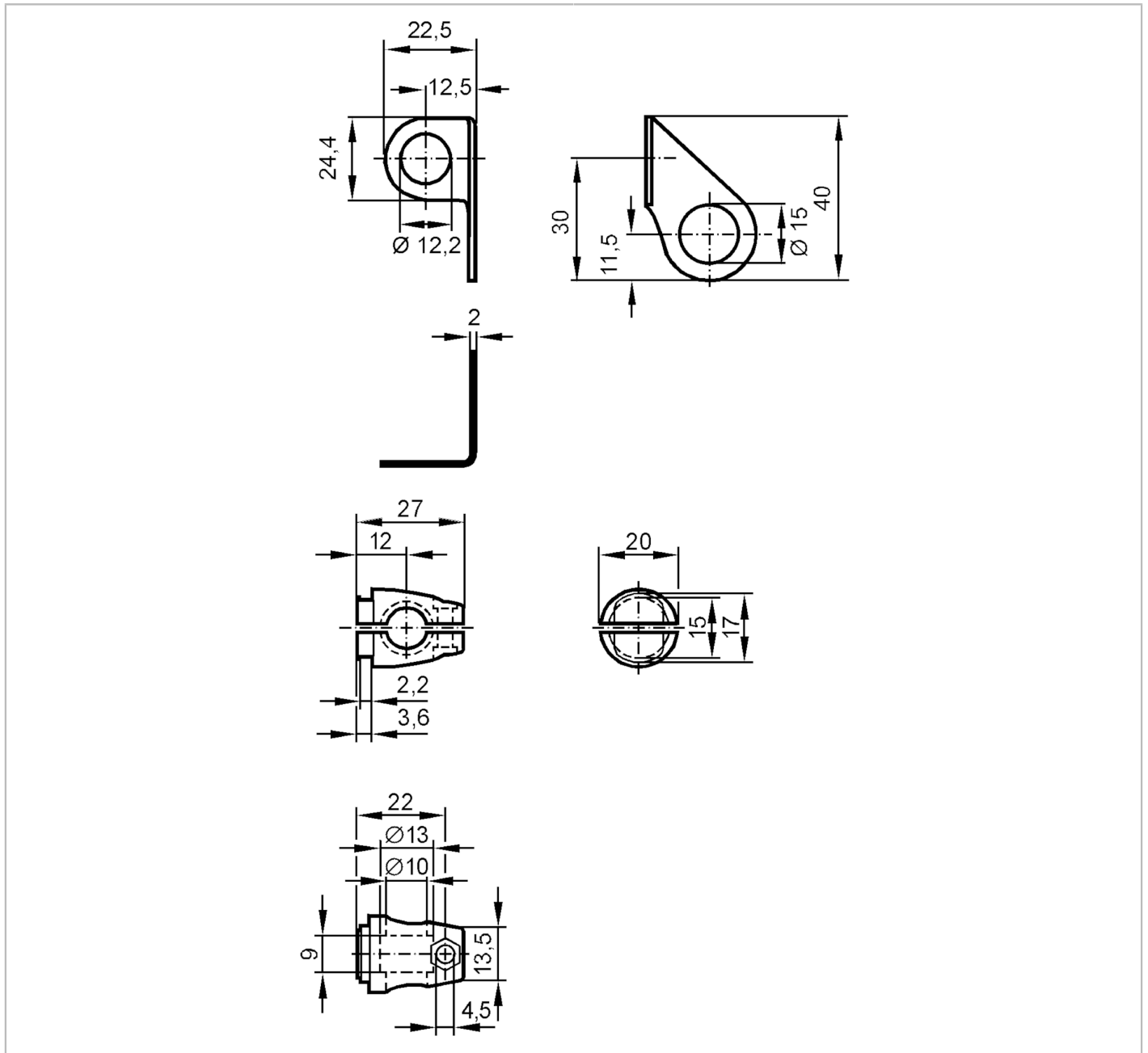

Mounting set for position sensors

SYSTEM COMPONENT M12 BOLT



Application	
Design	clamp mounting
Mechanical data	
Weight [g]	83
Type of mounting	free-standing; (M8)
Dimensions [mm]	$\varnothing 12.2$
Materials	fixture: stainless steel (316Ti/1.4571); Clamp: diecast zinc
Accessories	
Items supplied	screw: 1 x (M8 x 40 mm)
Remarks	
Pack quantity	1 pcs.