

E11989



Mounting adapter for position sensors used on rising stem valves

ADAPTER VALVIS_05

Article no longer available - archive entry

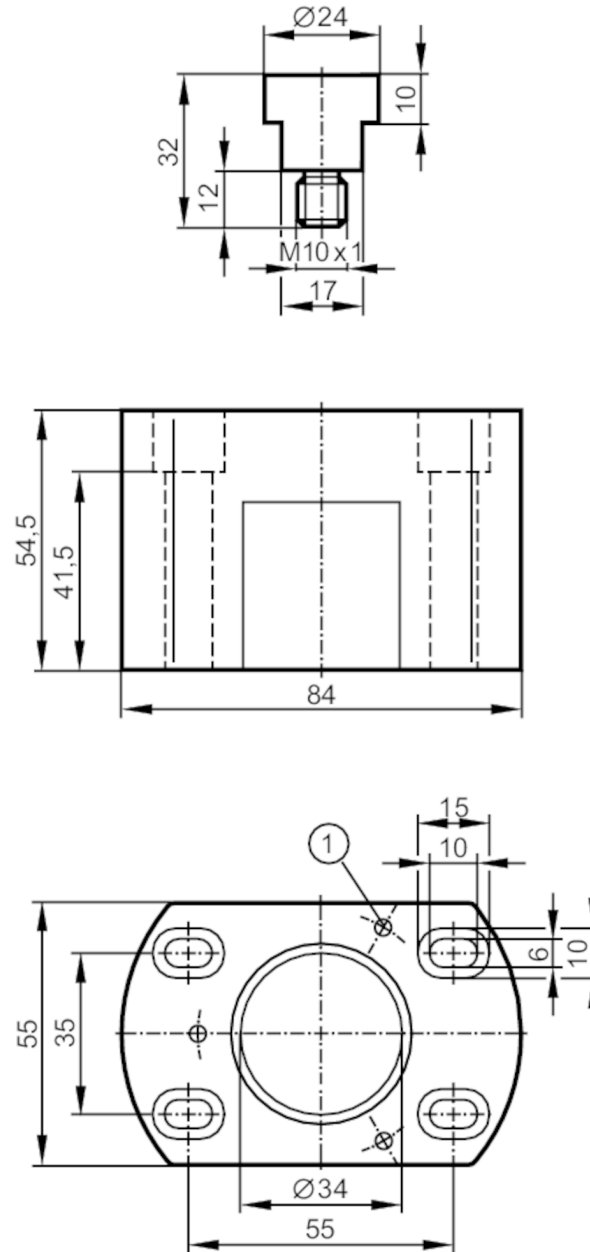

1 bore hole to fix the valve sensor on the adapter

Application	
Design	accessories for IX5010, IX5030, for valves Südmo
Mechanical data	
Weight [g]	375.4
Dimensions [mm]	54.5 x 55 x 84
Materials	Adapter: PA; Target: stainless steel (1.4404 / 316L)

E11989



Mounting adapter for position sensors used on rising stem valves

ADAPTER VALVIS_05

Accessories	
Items supplied	screws: 3, thread forming
	socket head screws: 4 x M5 x 45, stainless steel
	O-ring:, FKM
	sealing plugs
Remarks	
Pack quantity	1 pcs.