

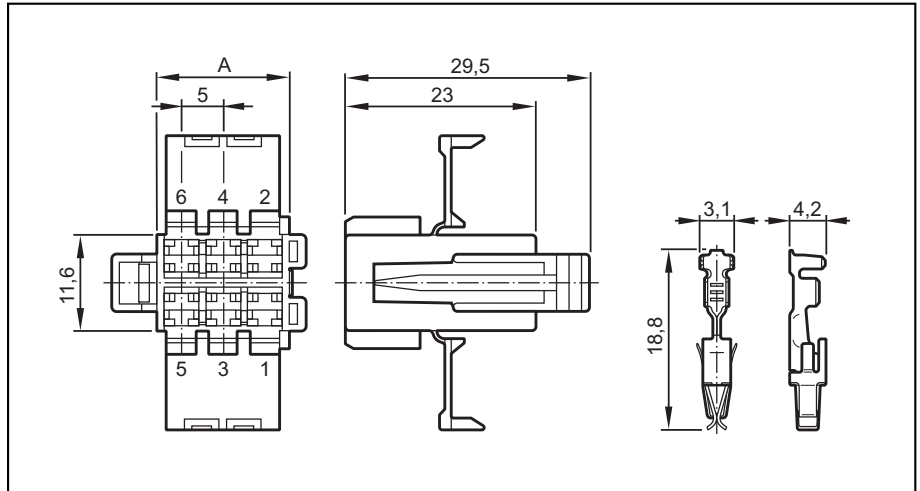

EC2053

Steckersatz
für
CabinetModule
CR2012/14
konfektionierbar



Technische Daten

**AMP Crimp-Buchsengehäuse
inkl. Crimp-Kontakte (Junior Power Timer)**

Lieferumfang
Gehäuse
Kontakte
Schutzart
Material (Gehäuse)
Material (Crimp-Kontakte)

1 x 6-polig, 2 x 18-polig
45
IP 20
PBT (schwarz)
CuSn (verzinkt)

DATEN100DB-FORM—PZD/03/12/96

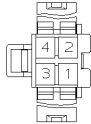
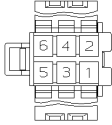
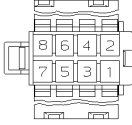
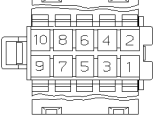
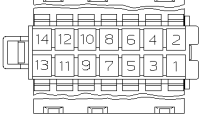
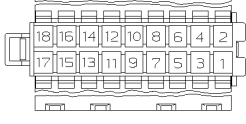
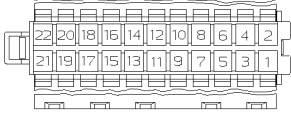
	A = 11	<input type="checkbox"/> 4-polig
	A = 16	<input checked="" type="checkbox"/> 6-polig
	A = 21	<input type="checkbox"/> 8-polig
	A = 26	<input type="checkbox"/> 10-polig
	A = 36	<input type="checkbox"/> 14-polig
	A = 46	<input checked="" type="checkbox"/> 18-polig
	A = 56	<input type="checkbox"/> 22-polig



EC2053

Plug set
for
CabinetModule
CR2012/14

wirable

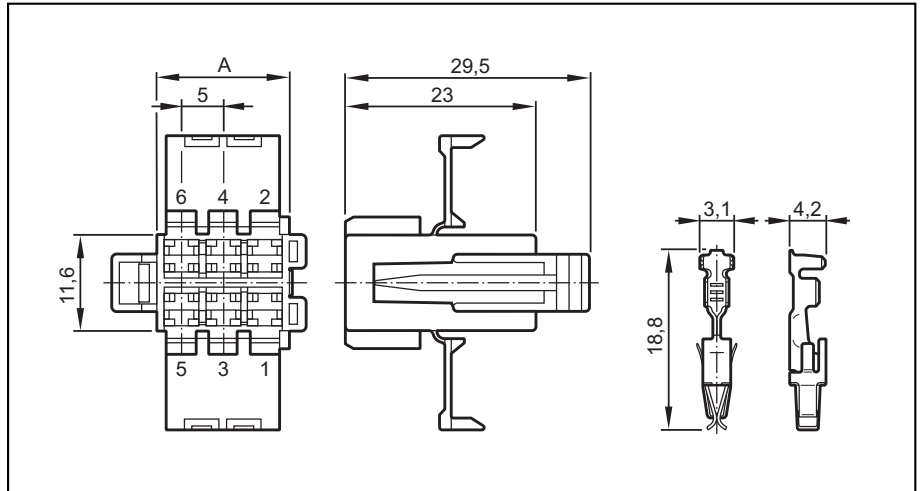

Technical data

**AMP Crimp housing
incl. Crimp contacts (Junior Power Timer)**

Components
housing
contacts

1 x 6 pins, 2 x 18 pins
45

Protection

IP 20

Material (housing)

PBT (black)

Material (contacts)

CuSn (tin plated)

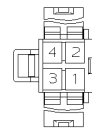

A = 11

4 pins

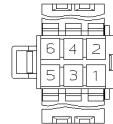

A = 16

6 pins

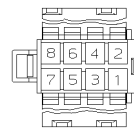

A = 21

8 pins

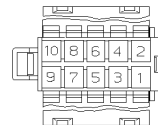

A = 26

10 pins



A = 36

14 pins

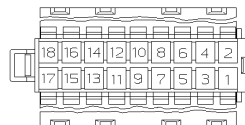

A = 46

18 pins

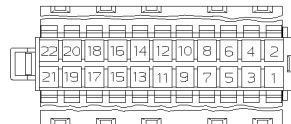

A = 56

22 pins