

## Flow sensor for connection to an evaluation unit

STR12ZBB

Article no longer available - archive entry

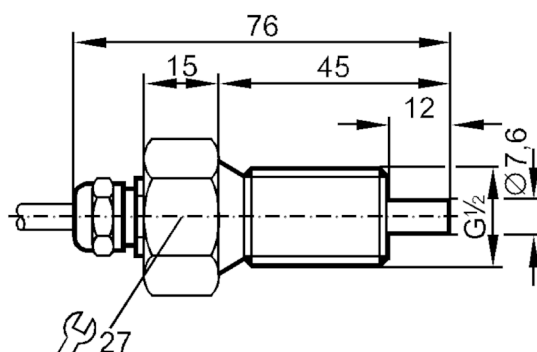

## Product characteristics

Process connection	G 1/2 external thread
--------------------	-----------------------

## Application

Application	high-temperature range
Media	Liquids; Gases
Pressure rating [bar]	30

## Liquids

Application	high-temperature range
Medium temperature [°C]	0...120

## Gases

Medium temperature [°C]	0...100
-------------------------	---------

## Electrical data

Connection to control monitor	VS 0100
-------------------------------	---------

## Measuring/setting range

## Liquids

Setting range [cm/s]	3...300
Greatest sensitivity [cm/s]	3...60

## Gases

Setting range [cm/s]	5...1500
----------------------	----------

## Accuracy / deviations

Temperature gradient [K/min]	15
------------------------------	----

## Response times

Response time [s]	1...10
-------------------	--------

# ST3300



## Flow sensor for connection to an evaluation unit

STR12ZBB

Liquids		
Response time	[s]	1...10
Gases		
Response time	[s]	1...10
Operating conditions		
Protection		IP 67
Mechanical data		
Housing		threaded type
Materials		stainless steel (316Ti/1.4571)
Process connection		G 1/2 external thread
Remarks		
Pack quantity		1 pcs.
Electrical connection		
Cable: 2 m, silicone; Maximum cable length: 100 m; 4 x 0.25 mm²		
Connection		

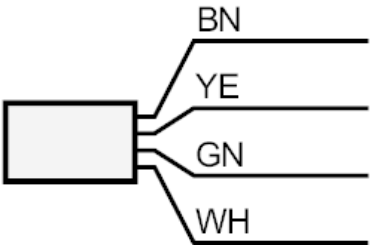

	Core colours :
BN =	brown
GN =	green
WH =	white
YE =	yellow