

Evaluation unit for level monitoring/control

L200/LC-1/110-240VAC 24VDC

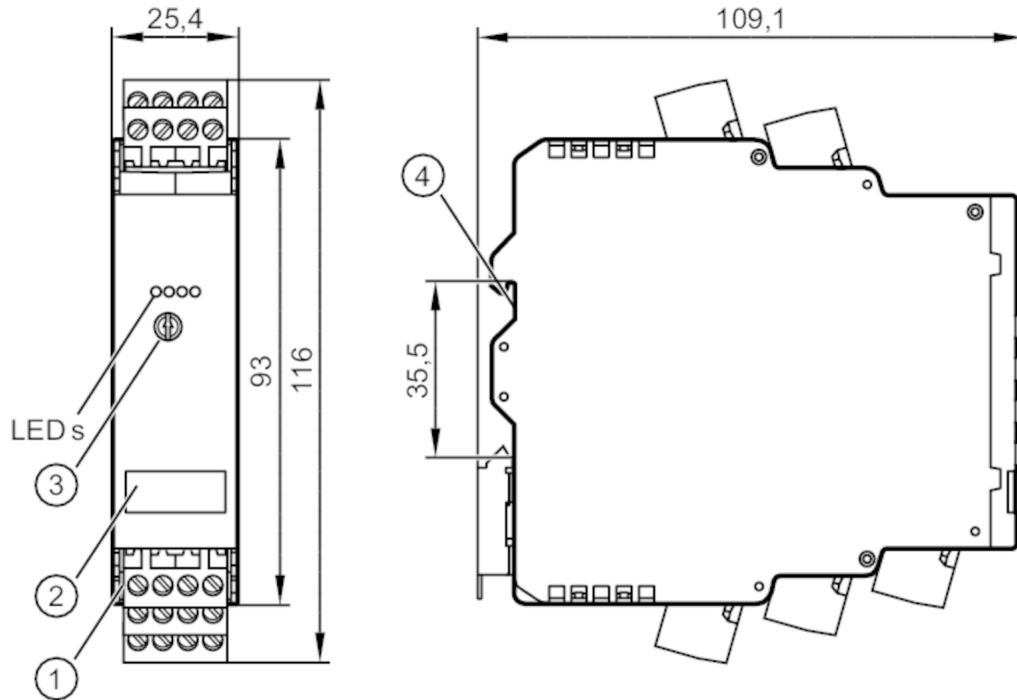

- 1 plug-in screw terminals
- 2 panel for labelling
- 3 potentiometer
- 4 mounting on DIN rail



Product characteristics

Housing	housing for DIN rail mounting
---------	-------------------------------

Application

Application	two-point control of levels
-------------	-----------------------------

Electrical data

Operating voltage tolerance 2	[%]	> 20
Nominal voltage AC	[V]	110...240
Nominal voltage DC	[V]	27
Nominal voltage tolerance	[%]	> 20
Nominal voltage tolerance 2	[%]	20...10
Nominal frequency AC	[Hz]	50...60
Insulation rating	[V]	9
Max. power consumption AC	[W]	6
Max. power consumption DC	[W]	4
Auxiliary energy for sensors DC	[V]	18.5...30; (SELV, ≤ 100 mA)

Inputs / outputs

Number of inputs and outputs	Number of digital outputs: 1; Number of relay outputs: 1
------------------------------	--

Outputs

Number of digital outputs	1
---------------------------	---



Evaluation unit for level monitoring/control

L200/LC-1/110-240VAC 24VDC

Number of relay outputs	1	
Contact rating	4 A (240 V AC, 24 V DC); (ohmic resistance)	
Short-circuit proof	yes	
Operating conditions		
Ambient temperature	[°C]	-25...60
Storage temperature	[°C]	-25...70
Max. relative air humidity	[%]	80; (40 °C: 50 % non condensing)
Max. height above sea level	[m]	2000
Protection	IP 20	
Protection rating terminals	IP 20	
Pollution degree	2; (≤ 240 V AC)	
Tests / approvals		
MTTF	[years]	254
UL approval	UL Approval no.	N001
Mechanical data		
Weight	[g]	235
Housing	housing for DIN rail mounting	
Type of mounting	rail; (TH35 EN 60715)	
Materials	plastics: PC-GF20	
Displays / operating elements		
Display	power supply	1 x LED, green
	Inputs	2 x LED, yellow
	Output	1 x LED, green
Accessories		
Items supplied	connector: 5 x 4-pole, with screw connection, E40173	

Evaluation unit for level monitoring/control

L200/LC-1/110-240VAC 24VDC

Electrical connection

pin headers: 4 x ; Spacing: 5.0 mm

Connection

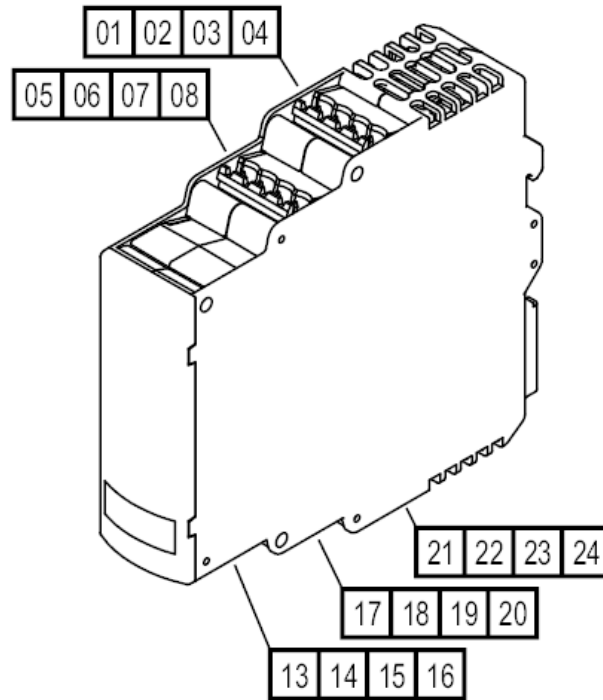

01	DC supply voltage (+)
02	DC supply voltage (+)
03	DC supply voltage (-)
04	DC supply voltage (-)
05	DC Sensor supply (+)
06	sensor signal 1 pnp
07	DC Sensor supply (-)
08	sensor signal 2 pnp
13	current supply transistor output (+)
14	transistor output pnp
15	common reference point external supply (-)
16	not used
17	relay normally open
18	relay common
19	relay normally closed
20	not used
21	AC supply voltage (L)
22	AC supply voltage (L)
23	AC supply voltage (N)
24	AC supply voltage (N)